

Developers and Manufacturers of Hydraulic Flanges & Components

## SOCKET WELD IN-LINE PIPE FLANGES

SAE BOLT PATTERN

62 SERIES

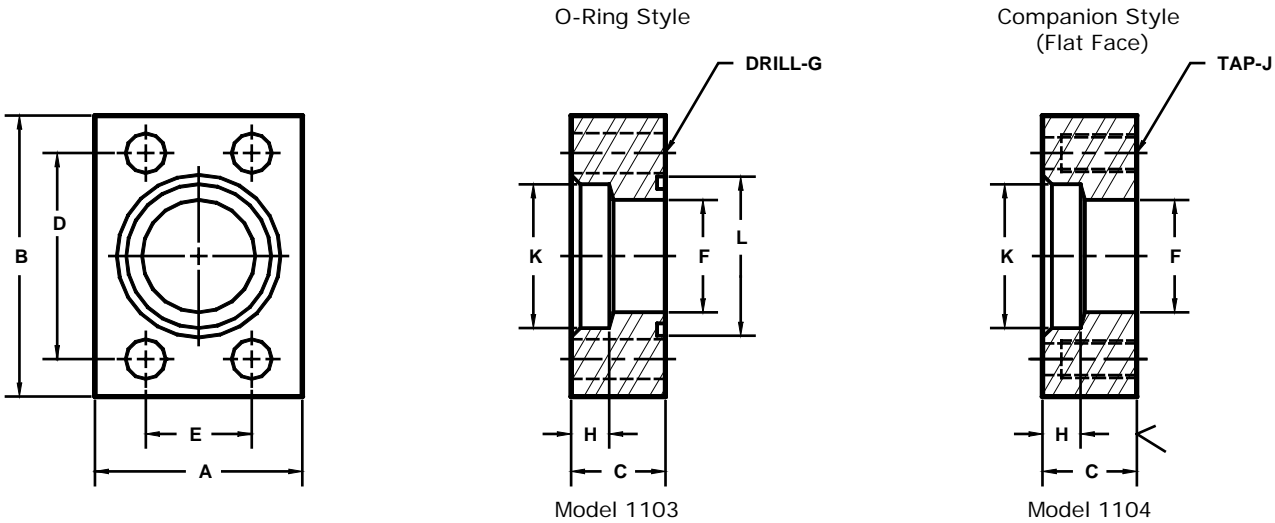

FLANGE SIZE	PIPE SIZE	PART NUMBER	A	B	C	D	E	F	G	H	J	K	L	MOUNTING KIT <sup>①</sup>		
														PART NO.	BOLT SIZE	O-RING
1/2	1/2	1103-08-08	1.75	2.22	1.00	1.594	.718	.50	.34	.50	5/16-18	.860	1.000	MK 512	5/16-18 X 1 1/2	210
		---							---				---			
1/2	3/4	1104-08-12	1.75	2.22	1.75	1.594	.718	.50	---	.50	5/16-18	1.070	---	---	---	---
		---							---				---			
3/4	1/2	1103-12-08	2.00	2.81	1.00	2.000	.937	.50	.41	.50	3/8-16	.860	1.250	MK 502	3/8-16 X 1 3/4	214
		---							---				---			
3/4	3/4	1103-12-12	2.00	2.81	1.00	2.000	.937	.75	.41	.50	3/8-16	1.070	1.250	MK 502	3/8-16 X 1 3/4	214
		---							---				---			
3/4	1	1104-12-16	2.25	2.81	1.00	2.000	.937	.75	---	.50	3/8-16	1.335	---	---	---	---
		---							---				---			
1	1/2	1103-16-08	2.25	3.19	1.00	2.250	1.093	.50	.47	.50	7/16-14	.860	1.562	MK 513	7/16-14 X 1 3/4	219
		---							---				---			
1	3/4	1103-16-12	2.25	3.19	1.00	2.250	1.093	.75	.47	.50	7/16-14	1.070	1.562	MK 513	7/16-14 X 1 3/4	219
		---							---				---			
1	1	1103-16-16	2.25	3.19	1.00	2.250	1.093	1.00	.47	.50	7/16-14	1.335	1.562	MK 513	7/16-14 X 1 3/4	219
		---							---				---			
1	1 1/4	1104-16-20	2.50	3.19	2.50	2.250	1.093	1.00	---	.50	7/16-14	1.680	---	---	---	---
		---							---				---			
1 1/4	1/2	1103-20-08	2.75	3.75	1.25	2.625	1.250	.50	.53	.50	1/2-13	.860	1.750	MK 514	1/2-13 X 2 1/4	222
		---							---				---			
1 1/4	3/4	1103-20-12	2.75	3.75	1.25	2.625	1.250	.75	.53	.50	1/2-13	1.070	1.750	MK 514	1/2-13 X 2 1/4	222
		---							---				---			
1 1/4	1	1103-20-16	2.75	3.75	1.25	2.625	1.250	1.00	.53	.50	1/2-13	1.335	1.750	MK 514	1/2-13 X 2 1/4	222
		---							---				---			
1 1/4	1 1/4	1103-20-20	2.75	3.75	1.25	2.625	1.250	1.25	.53	.50	1/2-13	1.680	1.750	MK 514	1/2-13 X 2 1/4	222
		---							---				---			
1 1/4	1 1/2	1104-20-24	3.00	3.75	2.00	2.625	1.250	1.25	---	.50	1/2-13	1.920	---	---	---	---
		---							---				---			

① Order Separately

MATERIAL : STEEL  
1/07

Developers and Manufacturers of Hydraulic Flanges & Components

## SOCKET WELD IN-LINE PIPE FLANGES

SAE BOLT PATTERN

62 SERIES

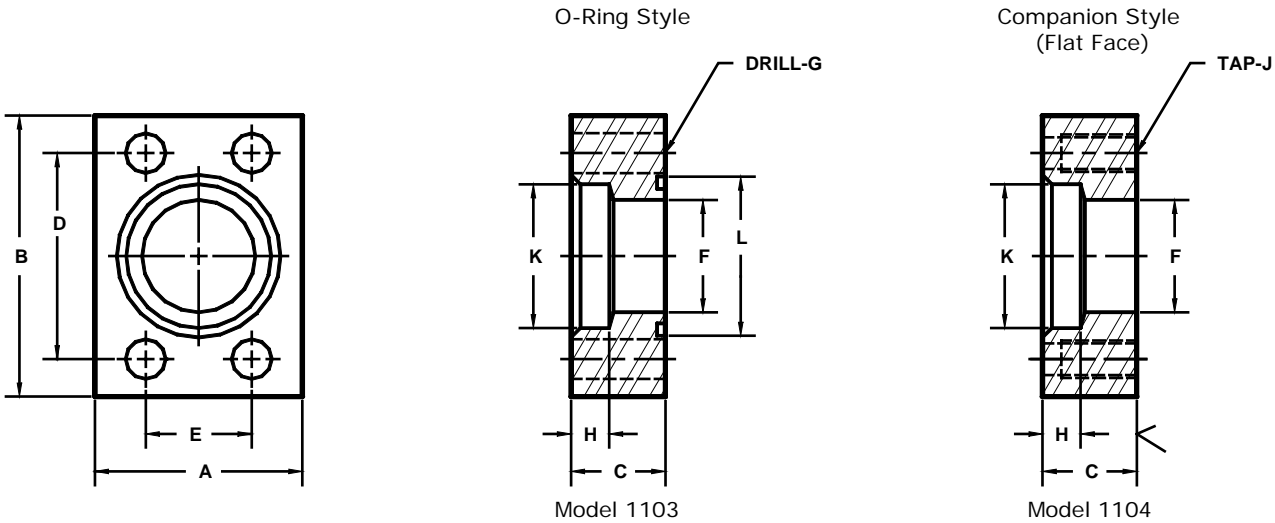

FLANGE SIZE	PIPE SIZE	PART NUMBER	A	B	C	D	E	F	G	H	J	K	L	MOUNTING KIT <sup>①</sup>		
														PART NO.	BOLT SIZE	O-RING
1½	¾	1103-24-12	3.25	4.50	1.50	3.125	1.437	.75	.66	.50	-----	1.070	2.125	MK 515	5/8-11 X 2 1/2	225
		1104-24-12							---							
1½	1	1103-24-16	3.25	4.50	1.50	3.125	1.437	1.00	.66	.50	-----	1.335	2.125	MK 515	5/8-11 X 2 1/2	225
		1104-24-16							---							
1½	1¼	1103-24-20	3.25	4.50	1.50	3.125	1.437	1.25	.66	.50	-----	1.680	2.125	MK 515	5/8-11 X 2 1/2	225
		1104-24-20							---							
1½	1½	1103-24-24	3.25	4.50	1.50	3.125	1.437	1.50	.66	.50	-----	1.920	2.125	MK 515	5/8-11 X 2 1/2	225
		1104-24-24							---							
1½	2	-----	4.00	4.50	3.00	3.125	1.437	1.50	---	.62	-----	2.411	---	-----	-----	---
		1104-24-32							---							
2	1¼	1103-32-20	4.00	5.25	1.75	3.812	1.750	1.25	.78	.50	-----	1.680	2.500	MK 516	3/4-10 X 3	228
		1104-32-20							---							
2	1½	1103-32-24	4.00	5.25	1.75	3.812	1.750	1.50	.78	.50	-----	1.920	2.500	MK 516	3/4-10 X 3	228
		1104-32-24							---							
2	2	1103-32-32	4.00	5.25	1.75	3.812	1.750	1.94	.78	.62	-----	2.411	2.500	MK 516	3/4-10 X 3	228
		1104-32-32							---							
2	2½	-----	5.00	5.50	3.00	3.812	1.750	1.94	---	.62	-----	2.911	---	-----	-----	---
		1104-32-40							---							
2½ <sup>②</sup>	2	1103-40-32	5.00	6.88	2.00	4.875	2.312	1.94	.94	.62	-----	2.411	3.000	MK 517	7/8-9 X 3 1/2	232
		1104-40-32							---							
2½ <sup>②</sup>	2½	1103-40-40	5.00	6.88	2.00	4.875	2.312	2.44	.94	.62	-----	2.911	3.000	MK 517	7/8-9 X 3 1/2	232
		1104-40-40							---							
2½ <sup>②</sup>	3	-----	5.00	6.88	2.00	4.875	2.312	2.44	---	.62	7/8-9	3.540	---	-----	-----	---
		1104-40-48							---							
3 <sup>②</sup>	2½	1103-48-40	6.00	8.50	2.50	6.000	2.812	2.44	1.19	.62	-----	2.911	3.625	MK 718	1 1/8-7 X 4 1/2	237
		1104-48-40							---							
3 <sup>②</sup>	3	1103-48-48	6.00	8.50	2.50	6.000	2.812	2.94	1.19	.62	-----	3.540	3.625	MK 718	1 1/8-7 X 4 1/2	237
		1104-48-48							---							

① Order Separately    ② Not included in SAE J518 specifications

MATERIAL : STEEL  
1/07