

Developers and Manufacturers of
Hydraulic Flanges & Components

SOCKET WELD IN-LINE TUBE FLANGES

SAE BOLT PATTERN

62 SERIES

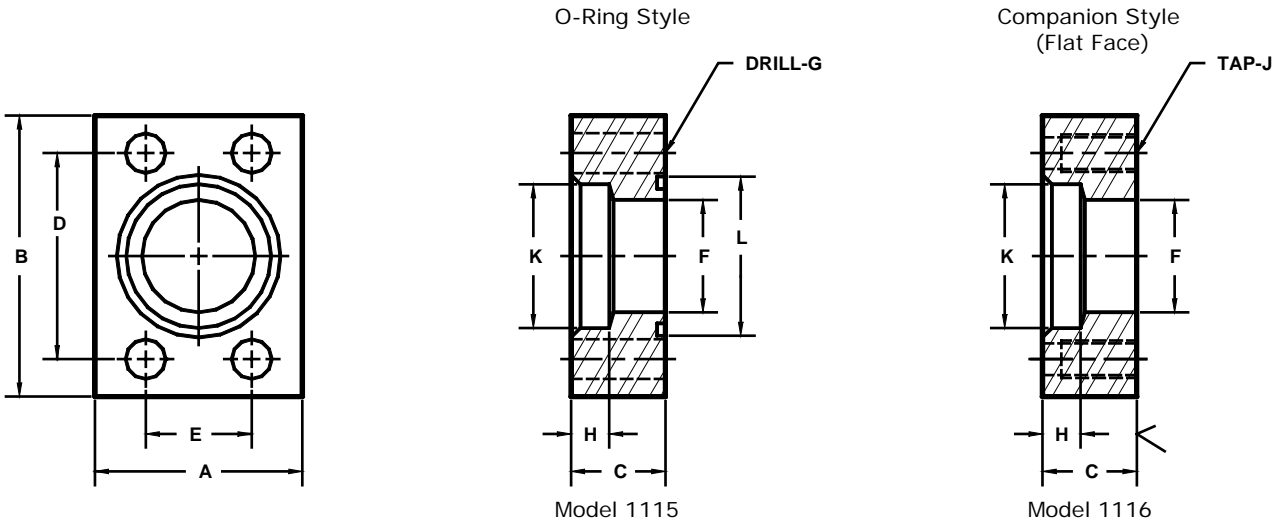

FLANGE SIZE	TUBE SIZE	PART NUMBER	A	B	C	D	E	F	G	H	J	K	L	MOUNTING KIT ^①		
														PART NO.	BOLT SIZE	O-RING
1/2	1/2	1115-08-08	1.75	2.22	1.00	1.594	.718	.31	.34	.50	-----	.510	1.000	MK 512	5/16-18 X 1 1/2	210
		1116-08-08							---				5/16-18	---	---	---
1/2	3/4	1115-08-12	1.75	2.22	1.00	1.594	.718	.50	.34	.50	-----	.760	1.000	MK 512	5/16-18 X 1 1/2	210
		1116-08-12							---				5/16-18	---	---	---
3/4	3/4	1115-12-12	2.00	2.81	1.00	2.000	.937	.50	.41	.50	-----	.760	1.250	MK 502	3/8-16 X 1 3/4	214
		1116-12-12							---				3/8-16	---	---	---
3/4	7/8	1115-12-14	2.00	2.81	1.00	2.000	.937	.75	.41	.50	-----	.885	1.250	MK 502	3/8-16 X 1 3/4	214
		1116-12-14							---				3/8-16	---	---	---
3/4	1	1115-12-16	2.00	2.81	1.00	2.000	.937	.75	.41	.50	-----	1.010	1.250	MK 502	3/8-16 X 1 3/4	214
		1116-12-16							---				3/8-16	---	---	---
1	1	1115-16-16	2.25	3.19	1.00	2.250	1.093	.75	.47	.50	-----	1.010	1.562	MK 513	7/16-14 X 1 3/4	219
		1116-16-16							---				7/16-14	---	---	---
1	1 1/4	1115-16-20	2.25	3.19	1.00	2.250	1.093	1.00	.47	.50	-----	1.260	1.562	MK 513	7/16-14 X 1 3/4	219
		1116-16-20							---				7/16-14	---	---	---
1 1/4	1 1/4	1115-20-20	2.75	3.75	1.25	2.625	1.250	1.00	.53	.50	-----	1.260	1.750	MK 514	1/2-13 X 2 1/4	222
		1116-20-20							---				1/2-13	---	---	---
1 1/4	1 1/2	1115-20-24	2.75	3.75	1.25	2.625	1.250	1.25	.53	.50	-----	1.510	1.750	MK 514	1/2-13 X 2 1/4	222
		1116-20-24							---				1/2-13	---	---	---
1 1/2	1 1/2	1115-24-24	3.25	4.50	1.50	3.125	1.437	1.25	.66	.50	-----	1.510	2.125	MK 515	5/8-11 X 2 1/2	225
		1116-24-24							---				5/8-11	---	---	---
1 1/2	1 3/4	1115-24-28	3.25	4.50	1.50	3.125	1.437	1.50	.66	.50	-----	1.760	2.125	MK 515	5/8-11 X 2 1/2	225
		1116-24-28							---				5/8-11	---	---	---
1 1/2	2	1115-24-32	3.25	4.50	1.50	3.125	1.437	1.50	.66	.50	-----	2.010	2.125	MK 515	5/8-11 X 2 1/2	225
		1116-24-32							---				5/8-11	---	---	---
2	2	1115-32-32	4.00	5.25	1.75	3.812	1.750	1.50	.78	.50	-----	2.010	2.500	MK 516	3/4-10 X 3	228
		1116-32-32							---				3/4-10	---	---	---
2	2 1/4	1115-32-36	4.00	5.25	1.75	3.812	1.750	1.94	.78	.62	-----	2.260	2.500	MK 516	3/4-10 X 3	228
		1116-32-36							---				3/4-10	---	---	---

① Order Separately

MATERIAL : STEEL
1/07