

Developers and Manufacturers of Hydraulic Flanges & Components

SOCKET WELD IN-LINE TUBE FLANGES

ISO 6162-2 PATTERN / J518 62 SERIES METRIC

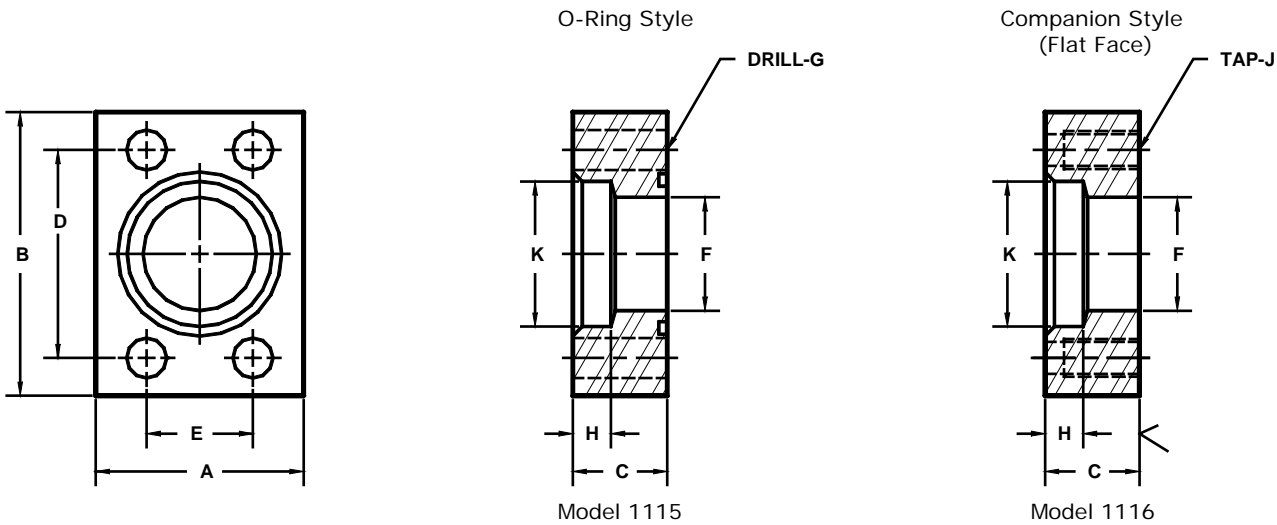

FLANGE SIZE		TUBE SIZE	PART NUMBER	A	B	C	D	E	F	G	H	J	K	MOUNTING KIT ^①		
														PART NO.	BOLT SIZE	O-RING
13	1/2	1/2	1115-08-08M8	44.5	56.5	25.0	40.49	18.24	7.9	8.5	12.7	----	12.95	MKM 512	M8 x 35	210
			1116-08-08M8				(1.594)	(.718)		---		(.510)	-----	-----	---	
13	1/2	3/4	1115-08-12M8	44.5	56.5	25.0	40.49	18.24	12.5	8.5	12.7	----	19.30	MKM 512	M8 x 35	210
			1116-08-12M8				(1.594)	(.718)		---		(.760)	-----	-----	---	
19	3/4	3/4	1115-12-12M10	51.0	71.5	25.0	50.80	23.80	12.5	10.5	12.7	----	19.30	MKM 502	M10 x 40	214
			1116-12-12M10				(2.000)	(.937)		---		(.760)	-----	-----	---	
19	3/4	1	1115-12-16M10	51.0	71.5	25.0	50.80	23.80	19.0	10.5	12.7	----	25.65	MKM 502	M10 x 40	214
			1116-12-16M10				(2.000)	(.937)		---		(1.010)	-----	-----	---	
25	1	1	1115-16-16M12	57.0	81.0	25.0	57.15	27.76	19.0	12.5	12.7	----	25.65	MKM 513	M12 x 45	219
			1116-16-16M12				(2.250)	(1.093)		---		(1.010)	-----	-----	---	
25	1	1 1/4	1115-16-20M12	57.0	81.0	25.0	57.15	27.76	25.0	12.5	12.7	----	32.00	MKM 513	M12 x 45	219
			1116-16-20M12				(2.250)	(1.093)		---		(1.260)	-----	-----	---	
32	1 1/4	1 1/4	1115-20-20M12	70.0	95.5	31.5	66.68	31.75	25.0	13.0	12.7	----	32.00	MKM 1502	M12 x 50	222
			1116-20-20M12				(2.625)	(1.250)		---		(1.260)	-----	-----	---	
32	1 1/4	1 1/4	1115-20-20M14*	70.0	95.5	31.5	66.68	31.75	25.0	15.0	12.7	----	32.00	MKM 514	M14 x 55	222
			1116-20-20M14*				(2.625)	(1.250)		---		(1.260)	-----	-----	---	
32	1 1/4	1 1/2	1115-20-24M12	70.0	95.5	31.5	66.68	31.75	31.5	13.0	12.7	----	38.35	MKM 1502	M12 x 50	222
			1116-20-24M12				(2.625)	(1.250)		---		(1.510)	-----	-----	---	
32	1 1/4	1 1/2	1115-20-24M14*	70.0	95.5	31.5	66.68	31.75	31.5	15.0	12.7	----	38.35	MKM 514	M14 x 55	222
			1116-20-24M14*				(2.625)	(1.250)		---		(1.510)	-----	-----	---	
38	1 1/2	1 1/2	1115-24-24M16	82.5	114.5	38.0	79.38	36.50	31.5	17.0	12.7	----	38.35	MKM 515	M16 x 60	225
			1116-24-24M16				(3.125)	(1.437)		---		(1.510)	-----	-----	---	
38	1 1/2	2	1115-24-32M16	82.5	114.5	38.0	79.38	36.50	38.0	17.0	12.7	----	51.05	MKM 515	M16 x 60	225
			1116-24-32M16				(3.125)	(1.437)		---		(2.010)	-----	-----	---	
51	2	2	1115-32-32M20	101.5	133.5	44.0	96.82	44.45	38.0	21.0	12.7	----	51.05	MKM 516	M20 x 70	228
			1116-32-32M20				(3.812)	(1.750)		---		(2.010)	-----	-----	---	

① Order Separately

*Non Standard Bolt For This Flange Size.

NOTE: DIMENSIONS ARE IN MILLIMETERS. INCH EQUIVALENTS IN ().

MATERIAL : STEEL
1/07