

Developers and Manufacturers of Hydraulic Flanges & Components

SCHEDULE 80 BUTT WELD ELBOW PIPE FLANGES

SAE BOLT PATTERN

61 SERIES

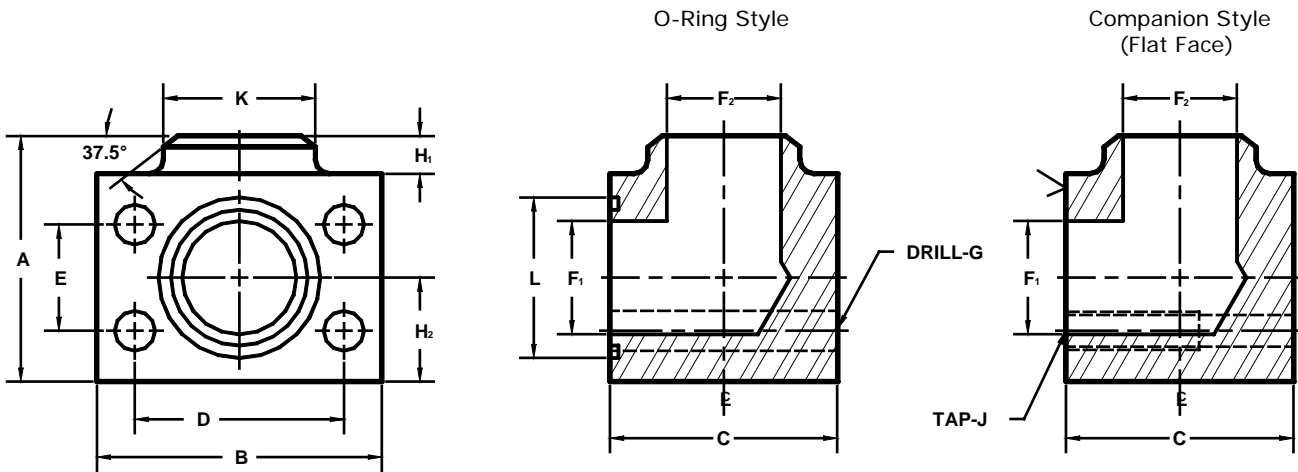

Model 1137

Model 1138

FLANGE SIZE	PIPE SIZE	PART NUMBER	A	B	C	D	E	F ₁	F ₂	G	H ₁	H ₂	J	K	L	MOUNTING KIT ^①		
																PART NO.	BOLT SIZE	O-RING
1/2	1/2	1137-08-08	2.00	2.12	1.44	1.500	.688	.50	.53	.34	.38	.75	-----	.88	1.000	MK 541	5/16-18 X 2	210
		1138-08-08								---								
1/2	3/4	1137-08-12	2.00	2.12	1.75	1.500	.688	.50	.73	.34	.38	.75	-----	1.12	1.000	MK 1552	5/16-18 X 2 1/4	210
		1138-08-12								---								
3/4	1/2	1137-12-08	2.25	2.62	1.70	1.875	.875	.75	.53	.41	.38	.88	-----	.88	1.250	MK 542	3/8-16 X 2 1/2	214
		1138-12-08								---								
3/4	3/4	1137-12-12	2.25	2.62	1.70	1.875	.875	.75	.73	.41	.38	.88	-----	1.12	1.250	MK 542	3/8-16 X 2 1/2	214
		1138-12-12								---								
3/4	1	1137-12-16	2.25	2.62	2.00	1.875	.875	.75	.94	.41	.38	.88	-----	1.38	1.250	MK 3513	3/8-16 X 2 3/4	214
		1138-12-16								---								
1	3/4	1137-16-12	2.50	2.82	1.94	2.062	1.031	1.00	.73	.41	.38	1.00	-----	1.12	1.562	MK 543	3/8-16 X 2 3/4	219
		1138-16-12								---								
1	1	1137-16-16	2.50	2.82	1.94	2.062	1.031	1.00	.94	.41	.38	1.00	-----	1.38	1.562	MK 543	3/8-16 X 2 3/4	219
		1138-16-16								---								
1	1 1/4	1137-16-20	2.50	2.82	2.50	2.062	1.031	1.00	1.23	.41	.38	1.00	-----	1.75	1.562	MK 577	3/8-16 X 3 1/4	219
		1138-16-20								---								
1 1/4	1	1137-20-16	3.00	3.19	2.40	2.312	1.188	1.25	.94	.47	.38	1.25	-----	1.38	1.750	MK 578	7/16-14 X 3 1/4	222
		1138-20-16								---								
1 1/4	1 1/4	1137-20-20	3.00	3.19	2.40	2.312	1.188	1.25	1.23	.47	.38	1.25	-----	1.75	1.750	MK 578	7/16-14 X 3 1/4	222
		1138-20-20								---								
1 1/4	1 1/2	1137-20-24	3.00	3.19	3.00	2.312	1.188	1.25	1.48	.47	.50	1.25	-----	2.00	1.750	MK 591	7/16-14 X 4	222
		1138-20-24								---								
1 1/2	1 1/4	1137-24-20	3.25	3.75	2.90	2.750	1.406	1.50	1.23	.53	.50	1.38	-----	1.75	2.125	MK 545	1/2-13 X 4	225
		1138-24-20								---								
1 1/2	1 1/2	1137-24-24	3.25	3.75	2.90	2.750	1.406	1.50	1.48	.53	.50	1.38	-----	2.00	2.125	MK 545	1/2-13 X 4	225
		1138-24-24								---								
1 1/2	2	1137-24-32	3.50	3.75	3.50	2.750	1.406	1.50	1.94	.53	.50	1.38	-----	2.50	2.125	MK 579	1/2-13 X 4 1/2	225
		1138-24-32								---								

① Order Separately

MATERIAL : STEEL
1/07

Developers and Manufacturers of Hydraulic Flanges & Components

SCHEDULE 80 BUTT WELD ELBOW PIPE FLANGES

SAE BOLT PATTERN

61 SERIES

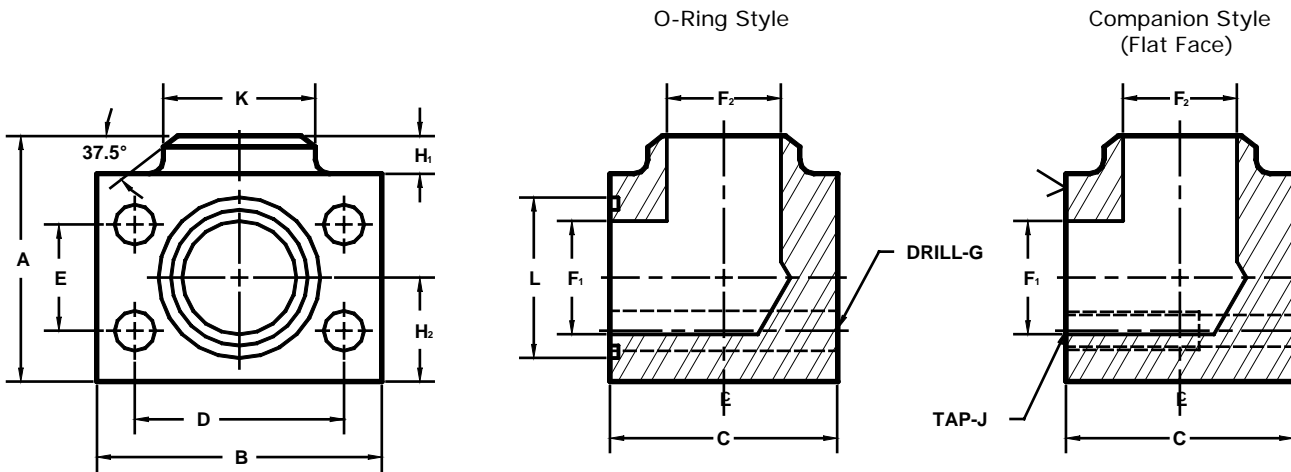

Model 1137

Model 1138

FLANGE SIZE	PIPE SIZE	PART NUMBER	A	B	C	D	E	F ₁	F ₂	G	H ₁	H ₂	J	K	L	MOUNTING KIT ^①		
																PART NO.	BOLT SIZE	O-RING
2	1 1/4	1137-32-20	3.75	4.00	3.40	3.062	1.688	1.94	1.23	.53	.50	1.62	-----	1.75	2.500	MK 546	1/2-13 X 4 1/2	228
		1138-32-20								---								
2	1 1/2	1137-32-24	3.75	4.00	3.40	3.062	1.688	1.94	1.48	.53	.50	1.62	-----	2.00	2.500	MK 546	1/2-13 X 4 1/2	228
		1138-32-24								---								
2	2	1137-32-32	3.75	4.00	3.40	3.062	1.688	1.94	1.94	.53	.50	1.62	-----	2.50	2.500	MK 546	1/2-13 X 4 1/2	228
		1138-32-32								---								
2 1/2 ^②	1 1/2	1137-40-24	4.50	4.50	3.96	3.500	2.000	2.44	1.48	.53	.50	2.00	-----	2.00	3.000	MK 547	1/2-13 X 5	232
		1138-40-24								---								
2 1/2 ^②	2	1137-40-32	4.50	4.50	3.96	3.500	2.000	2.44	1.94	.53	.50	2.00	-----	2.50	3.000	MK 547	1/2-13 X 5	232
		1138-40-32								---								
2 1/2 ^②	2 1/2	1137-40-40	4.50	4.50	3.96	3.500	2.000	2.44	2.32	.53	.50	2.00	-----	3.00	3.000	MK 547	1/2-13 X 5	232
		1138-40-40								---								
3 ^③	2	1137-48-32	5.00	5.31	4.96	4.188	2.438	2.94	1.94	.66	.50	2.25	-----	2.50	3.625	MK 548	5/8-11 X 6	237
		1138-48-32								---								
3 ^③	2 1/2	1137-48-40	5.00	5.31	4.96	4.188	2.438	2.94	2.32	.66	.50	2.25	-----	3.00	3.625	MK 548	5/8-11 X 6	237
		1138-48-40								---								
3 ^③	3	1137-48-48	5.00	5.31	4.96	4.188	2.438	2.94	2.90	.66	.50	2.25	-----	3.50	3.625	MK 548	5/8-11 X 6	237
		1138-48-48								---								
3 1/2 ^④	2 1/2	1137-56-40	5.50	6.00	5.40	4.750	2.750	3.44	2.32	.66	.50	2.50	-----	3.00	4.109	MK 549	5/8-11 X 6 1/2	241
		1138-56-40								---								
3 1/2 ^④	3	1137-56-48	5.50	6.00	5.40	4.750	2.750	3.44	2.90	.66	.50	2.50	-----	3.50	4.109	MK 549	5/8-11 X 6 1/2	241
		1138-56-48								---								
3 1/2 ^④	3 1/2	1137-56-56	5.50	6.00	5.40	4.750	2.750	3.44	3.36	.66	.50	2.50	-----	4.00	4.109	MK 549	5/8-11 X 6 1/2	241
		1138-56-56								---								
4 ^④	3	1137-64-48	6.00	6.38	5.96	5.125	3.062	3.94	2.90	.66	.50	2.75	-----	3.50	4.609	MK 550	5/8-11 X 7	245
		1138-64-48								---								
4 ^④	4	1137-64-64	6.00	6.38	5.96	5.125	3.062	3.94	3.83	.66	.50	2.75	-----	4.50	4.609	MK 550	5/8-11 X 7	245
		1138-64-64								---								

① Order Separately ② 2500 PSI Max ③ 2000 PSI Max ④ 500 PSI Max

MATERIAL : STEEL
1/07