

Developers and Manufacturers of Hydraulic Flanges & Components

SCHEDULE 80 BUTT WELD ELBOW PIPE FLANGES

ISO 6162-1 PATTERN / J518 61 SERIES METRIC

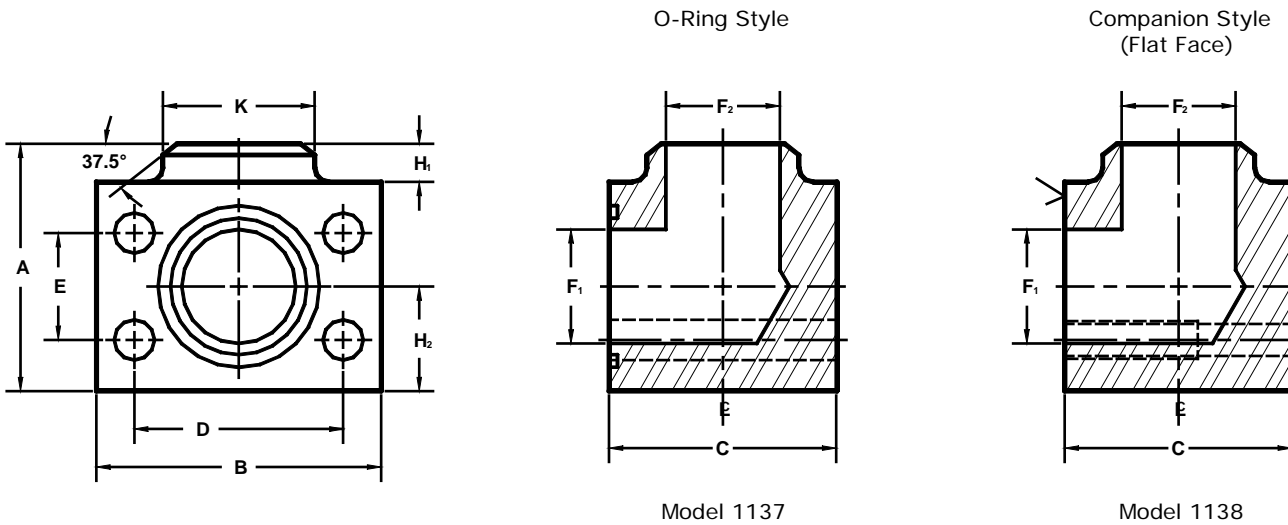

FLANGE SIZE	PIPE SIZE	PART NUMBER	A	B	C	D	E	F ₁	F ₂	H ₁	H ₂	K	MOUNTING KIT ^①		
													PART NO.	BOLT SIZE	O-RING
13	1/2	1137-08-08M8	51.0	54.0	36.5	38.10 (1.500)	17.48 (.688)	12.5	13.5	9.7	19.0	22.4	MKM 541	M8 x 50	210
		1138-08-08M8											-----	---	
19	3/4	1137-12-08M10	57.0	66.5	43.0	47.63 (1.875)	22.23 (.875)	19.0	13.5	9.7	22.4	22.4	MKM 542	M10 x 60	214
		1138-12-08M10											-----	---	
19	3/4	1137-12-12M10	57.0	66.5	43.0	47.63 (1.875)	22.23 (.875)	19.0	19.0	9.7	22.4	28.4	MKM 542	M10 x 60	214
		1138-12-12M10											-----	---	
25	1	1137-16-12M10	63.5	71.5	49.5	52.37 (2.062)	26.19 (1.031)	25.0	19.0	9.7	25.4	28.4	MKM 543	M10 x 65	219
		1138-16-12M10											-----	---	
25	1	1137-16-16M10	63.5	71.5	49.5	52.37 (2.062)	26.19 (1.031)	25.0	23.8	9.7	25.4	35.1	MKM 543	M10 x 65	219
		1138-16-16M10											-----	---	
32	1 1/4	1137-20-16M10	76.0	81.0	61.0	58.72 (2.312)	30.18 (1.188)	31.5	23.8	9.7	31.8	35.1	MKM 4532	M10 x 75	222
		1138-20-16M10											-----	---	
32	1 1/4	1137-20-16M12*	76.0	81.0	61.0	58.72 (2.312)	30.18 (1.188)	31.5	23.8	9.7	31.8	35.1	MKM 578	M12 x 80	222
		1138-20-16M12*											-----	---	
32	1 1/4	1137-20-20M10	76.0	81.0	61.0	58.72 (2.312)	30.18 (1.188)	31.5	31.5	9.7	31.8	44.5	MKM 4532	M10 x 75	222
		1138-20-20M10											-----	---	
32	1 1/4	1137-20-20M12*	76.0	81.0	61.0	58.72 (2.312)	30.18 (1.188)	31.5	31.5	9.7	31.8	44.5	MKM 578	M12 x 80	222
		1138-20-20M12*											-----	---	
38	1 1/2	1137-24-20M12	82.5	95.5	73.5	69.85 (2.750)	35.71 (1.406)	38.0	31.5	12.7	35.1	44.5	MKM 4533	M12 x 90	225
		1138-24-20M12											-----	---	
38	1 1/2	1137-24-20M14*	82.5	95.5	73.5	69.85 (2.750)	35.71 (1.406)	38.0	31.5	12.7	35.1	44.5	MKM 545	M14 x 100	225
		1138-24-20M14*											-----	---	
38	1 1/2	1137-24-24M12	82.5	95.5	73.5	69.85 (2.750)	35.71 (1.406)	38.0	38.0	12.7	35.1	50.8	MKM 4533	M12 x 90	225
		1138-24-24M12											-----	---	
38	1 1/2	1137-24-24M14*	82.5	95.5	73.5	69.85 (2.750)	35.71 (1.406)	38.0	38.0	12.7	35.1	50.8	MKM 545	M14 x 100	225
		1138-24-24M14*											-----	---	

① Order Separately

* Non Standard Bolt For This Flange Size.

MATERIAL : STEEL
1/07

NOTE: DIMENSIONS ARE IN MILLIMETERS. INCH EQUIVALENTS IN ().

Developers and Manufacturers of Hydraulic Flanges & Components

SCHEDULE 80 BUTT WELD ELBOW PIPE FLANGES

ISO 6162-1 PATTERN / J518 61 SERIES METRIC

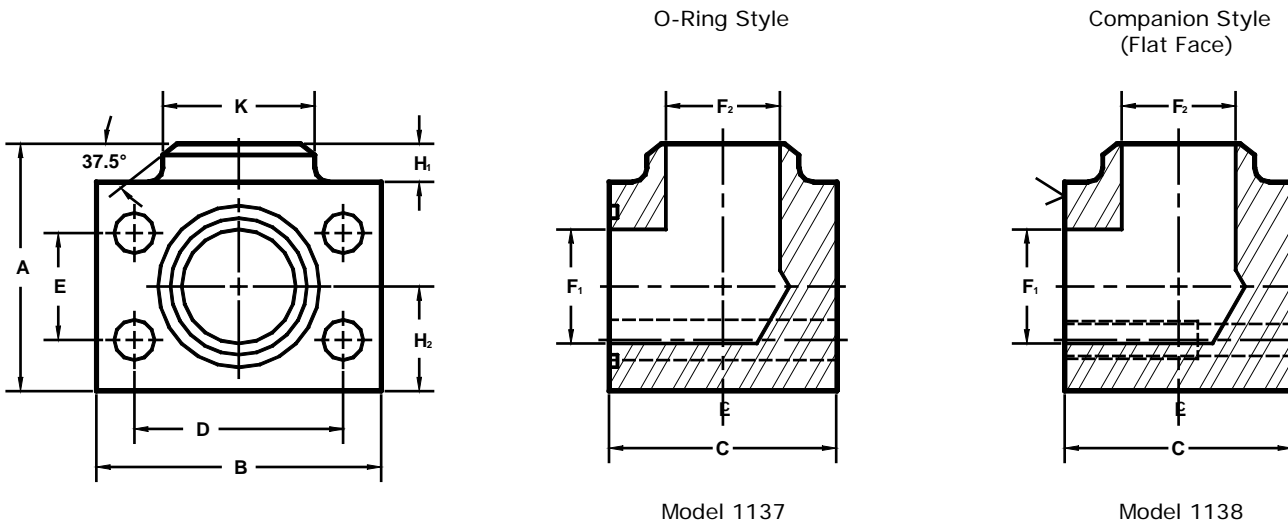

FLANGE SIZE	PIPE SIZE	PART NUMBER	A	B	C	D	E	F ₁	F ₂	H ₁	H ₂	K	MOUNTING KIT ^①		
													PART NO.	BOLT SIZE	O-RING
51	2	1½	95.5	101.5	86.5	77.77 (3.062)	42.88 (1.688)	49.2	38.0	12.7	41.1	50.8	MKM 4534	M12 x 100	228
		1137-32-24M12											-----	---	
51	2	1½*	95.5	101.5	86.5	77.77 (3.062)	42.88 (1.688)	49.2	38.0	12.7	41.1	50.8	MKM 546	M14 x 110	228
		1137-32-24M14*											-----	---	
51	2	2	95.5	101.5	86.5	77.77 (3.062)	42.88 (1.688)	49.2	49.2	12.7	41.1	63.5	MKM 4534	M12 x 100	228
		1137-32-32M12											-----	---	
51	2	2	95.5	101.5	86.5	77.77 (3.062)	42.88 (1.688)	49.2	49.2	12.7	41.1	63.5	MKM 546	M14 x 110	228
		1137-32-32M14*											-----	---	
64 ^②	2½	2½	114.0	114.0	100.5	88.90 (3.500)	50.80 (2.000)	62.0	59.0	12.7	50.8	76.2	MKM 4535	M12 x 120	232
		1137-40-40M12											-----	---	
64 ^②	2½	2½*	114.0	114.0	100.5	88.90 (3.500)	50.80 (2.000)	62.0	59.0	12.7	50.8	76.2	MKM 547	M14 x 120	232
		1137-40-40M14*											-----	---	
76 ^③	3	2	127.0	135.0	126.0	106.38 (4.188)	61.93 (2.438)	74.6	49.2	12.7	57.2	63.5	MKM 548	M16 x 150	237
		1137-48-32M16											-----	---	
76 ^③	3	2½	127.0	135.0	126.0	106.38 (4.188)	61.93 (2.438)	74.6	59.0	12.7	57.2	76.2	MKM 548	M16 x 150	237
		1137-48-40M16											-----	---	
76 ^③	3	3	127.0	135.0	126.0	106.38 (4.188)	61.93 (2.438)	74.6	73.6	12.7	57.2	88.9	MKM 548	M16 x 150	237
		1137-48-48M16											-----	---	
89 ^④	3½	3	139.5	152.5	137.0	120.65 (4.750)	69.85 (2.750)	87.3	73.6	12.7	63.5	88.9	MKM 549	M16 x 160	241
		1137-56-48M16											-----	---	
89 ^④	3½	3½	139.5	152.5	137.0	120.65 (4.750)	69.85 (2.750)	87.3	85.3	12.7	63.5	101.5	MKM 549	M16 x 160	241
		1137-56-56M16											-----	---	
102 ^④	4	3	152.5	162.0	151.5	130.18 (5.125)	77.77 (3.062)	100.0	73.6	12.7	70.0	88.9	MKM 550	M16 x 180	245
		1137-64-48M16											-----	---	
102 ^④	4	4	152.5	162.0	151.5	130.18 (5.125)	77.77 (3.062)	100.0	97.3	12.7	70.0	114.3	MKM 550	M16 x 180	245
		1137-64-64M16											-----	---	

① Order Separately ② 16 MPa Max ③ 10 MPa Max ④ 2.5 MPa Max
* Non Standard Bolt For This Flange Size.

MATERIAL : STEEL
1/07

NOTE: DIMENSIONS ARE IN MILLIMETERS. INCH EQUIVALENTS IN ().