

Developers and Manufacturers of
Hydraulic Flanges & Components

SCHEDULE 80 BUTT WELD ELBOW PIPE FLANGES

ISO 6162-2 PATTERN / J518 62 SERIES METRIC

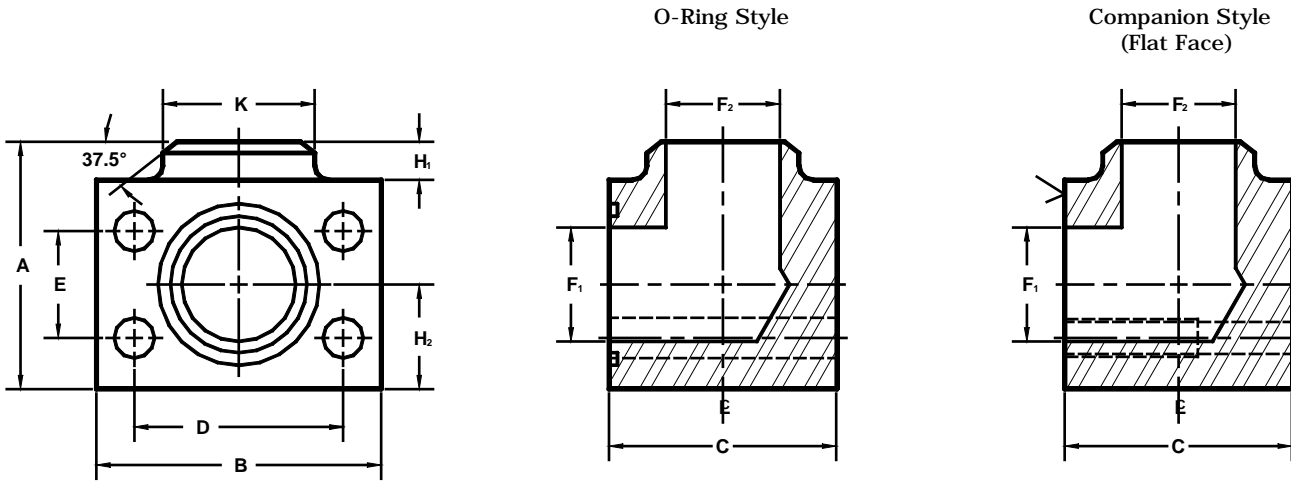

Model 1139

Model 1140

FLANGE SIZE	PIPE SIZE	PART NUMBER	A	B	C	D	E	F ₁	F ₂	H ₁	H ₂	K	MOUNTING KIT ^①		
													PART NO.	BOLT SIZE	O-RING
13	1/2	1139-08-08M8	57.0	56.5	37.0	40.49	18.24	12.5	13.5	9.7	22.4	22.4	MKM 541	M8 x 50	210
		1140-08-08M8				(1.594)	(.718)						-----	-----	---
19	3/4	1139-12-12M10	63.5	71.5	43.0	50.80	23.80	19.0	19.0	9.7	25.4	28.4	MKM 542	M10 x 60	214
		1140-12-12M10				(2.000)	(.937)						-----	-----	---
25	1	1139-16-12M12	70.0	81.0	56.0	57.15	27.76	25.0	19.0	9.7	28.4	28.4	MKM 2533	M12 x 75	219
		1140-16-12M12				(2.250)	(1.093)						-----	-----	---
25	1	1139-16-16M12	70.0	81.0	56.0	57.15	27.76	25.0	25.0	9.7	28.4	35.1	MKM 2533	M12 x 75	219
		1140-16-16M12				(2.250)	(1.093)						-----	-----	---
32	1 1/4	1139-20-20M12	82.5	95.5	62.0	66.68	31.75	31.5	31.5	9.7	35.0	44.5	MKM 578	M12 x 80	222
		1140-20-20M12				(2.625)	(1.250)						-----	-----	---
32	1 1/4	1139-20-20M14*	82.5	95.5	62.0	66.68	31.75	31.5	31.5	9.7	35.0	44.5	MKM 1530	M14 x 80	222
		1140-20-20M14*				(2.625)	(1.250)						-----	-----	---
38	1 1/2	1139-24-20M16	95.5	114.5	75.0	79.38	36.50	38.0	31.5	12.7	41.1	44.5	MKM 553	M16 x 100	225
		1140-24-20M16				(3.125)	(1.437)						-----	-----	---
38	1 1/2	1139-24-24M16	95.5	114.5	75.0	79.38	36.50	38.0	38.0	12.7	41.1	50.8	MKM 553	M16 x 100	225
		1140-24-24M16				(3.125)	(1.437)						-----	-----	---
51	2	1139-32-24M20	114.0	133.5	88.0	96.82	44.45	49.2	38.0	12.7	50.8	50.8	MKM 554	M20 x 120	228
		1140-32-24M20				(3.812)	(1.750)						-----	-----	---
51	2	1139-32-32M20	114.0	133.5	88.0	96.82	44.45	49.2	49.2	12.7	50.8	63.5	MKM 554	M20 x 120	228
		1140-32-32M20				(3.812)	(1.750)						-----	-----	---
64 ^②	2 1/2	1139-40-32M24	139.5	175.0	114.5	123.82	58.72	62.0	49.2	12.7	63.5	63.5	MKM 2557	M24 x 150	232
		1140-40-32M24				(4.875)	(2.312)						-----	-----	---
64 ^②	2 1/2	1139-40-40M24	139.5	175.0	114.5	123.82	58.72	62.0	59.0	12.7	63.5	76.2	MKM 2557	M24 x 150	232
		1140-40-40M24				(4.875)	(2.312)						-----	-----	---
76 ^②	3	1139-48-48M30	165.0	216.0	127.0	152.40	71.42	74.6	73.6	12.7	76.2	88.9	MKM 556	M30 x 180	237
		1140-48-48M30				(6.000)	(2.812)						-----	-----	---

① Order Separately ② Not included in ISO 6162 / J518 specifications

MATERIAL : STEEL

* Non Standard Bolt For This Flange Size.

1/07

NOTE: DIMENSIONS ARE IN MILLIMETERS. INCH EQUIVALENTS IN ().