

Developers and Manufacturers of Hydraulic Flanges & Components

SCHEDULE 160 BUTT WELD ELBOW PIPE FLANGES

SAE BOLT PATTERN

61 SERIES

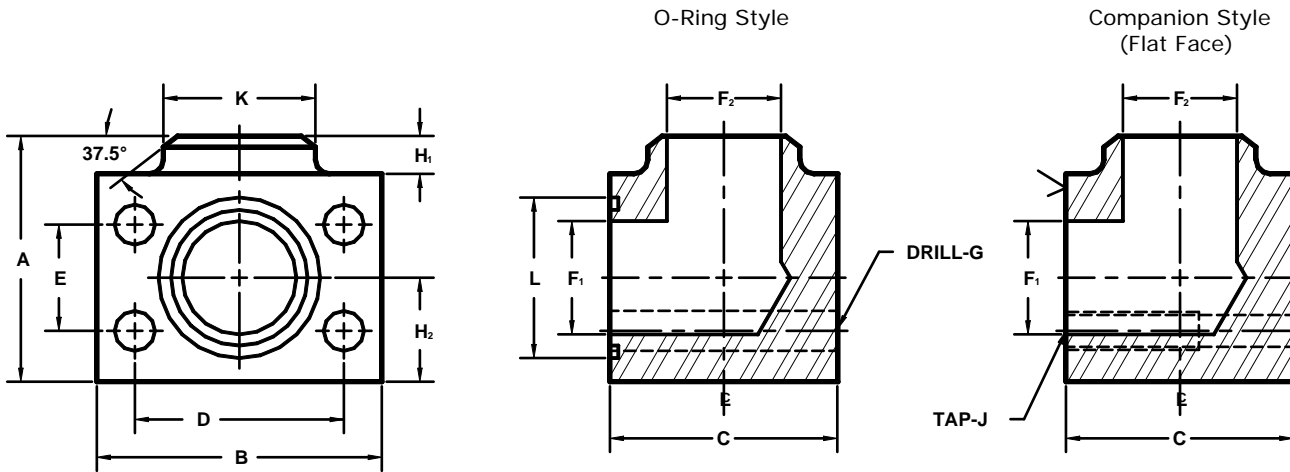

Model 1141

Model 1142

FLANGE SIZE	PIPE SIZE	PART NUMBER	A	B	C	D	E	F ₁	F ₂	G	H ₁	H ₂	J	K	L	MOUNTING KIT [Ⓢ]		
																PART NO.	BOLT SIZE	O-RING
1/2	1/2	1141-08-08	2.00	2.12	1.44	1.500	.688	.50	.47	.34	.38	.75	----	.88	1.000	MK 541	5/16-18 X 2	210
		1142-08-08											5/16-18					
1/2	3/4	1141-08-12	2.00	2.12	1.75	1.500	.688	.50	.61	.34	.38	.75	----	1.12	1.000	MK 1552	5/16-18 X 2 1/4	210
		1142-08-12											5/16-18					
3/4	1/2	1141-12-08	2.25	2.62	1.70	1.875	.875	.75	.47	.41	.38	.88	----	.88	1.250	MK 542	3/8-16 X 2 1/2	214
		1142-12-08											3/8-16					
3/4	3/4	1141-12-12	2.25	2.62	1.70	1.875	.875	.75	.61	.41	.38	.88	----	1.12	1.250	MK 542	3/8-16 X 2 1/2	214
		1142-12-12											3/8-16					
3/4	1	1141-12-16	2.25	2.62	2.00	1.875	.875	.75	.81	.41	.38	.88	----	1.38	1.250	MK 3513	3/8-16 X 2 3/4	214
		1142-12-16											3/8-16					
1	3/4	1141-16-12	2.50	2.82	1.94	2.062	1.031	1.00	.61	.41	.38	1.00	----	1.12	1.562	MK 543	3/8-16 X 2 3/4	219
		1142-16-12											3/8-16					
1	1	1141-16-16	2.50	2.82	1.94	2.062	1.031	1.00	.81	.41	.38	1.00	----	1.38	1.562	MK 543	3/8-16 X 2 3/4	219
		1142-16-16											3/8-16					
1	1 1/4	1141-16-20	2.50	3.00	2.50	2.062	1.031	1.00	1.16	.41	.38	1.00	----	1.75	1.562	MK 577	3/8-16 X 3 1/4	219
		1142-16-20											3/8-16					
1 1/4	1	1141-20-16	3.00	3.19	2.40	2.312	1.188	1.25	.81	.47	.38	1.25	----	1.38	1.750	MK 578	7/16-14 X 3 1/4	222
		1142-20-16											7/16-14					
1 1/4	1 1/4	1141-20-20	3.00	3.19	2.40	2.312	1.188	1.25	1.16	.47	.38	1.25	----	1.75	1.750	MK 578	7/16-14 X 3 1/4	222
		1142-20-20											7/16-14					
1 1/4	1 1/2	1141-20-24	3.00	3.19	3.00	2.312	1.188	1.25	1.34	.47	.50	1.25	----	2.00	1.750	MK 591	7/16-14 X 4	222
		1142-20-24											7/16-14					
1 1/2	1 1/4	1141-24-20	3.25	3.75	2.90	2.750	1.406	1.50	1.16	.53	.50	1.38	----	1.75	2.125	MK 545	1/2-13 X 4	225
		1142-24-20											1/2-13					
1 1/2	1 1/2	1141-24-24	3.25	3.75	2.90	2.750	1.406	1.50	1.34	.53	.50	1.38	----	2.00	2.125	MK 545	1/2-13 X 4	225
		1142-24-24											1/2-13					
1 1/2	2	1141-24-32	3.50	3.75	3.50	2.750	1.406	1.50	1.69	.53	.50	1.38	----	2.50	2.125	MK 579	1/2-13 X 4 1/2	225
		1142-24-32											1/2-13					

Ⓢ Order Separately

MATERIAL : STEEL
1/07

Developers and Manufacturers of Hydraulic Flanges & Components

SCHEDULE 160 BUTT WELD ELBOW PIPE FLANGES

SAE BOLT PATTERN

61 SERIES

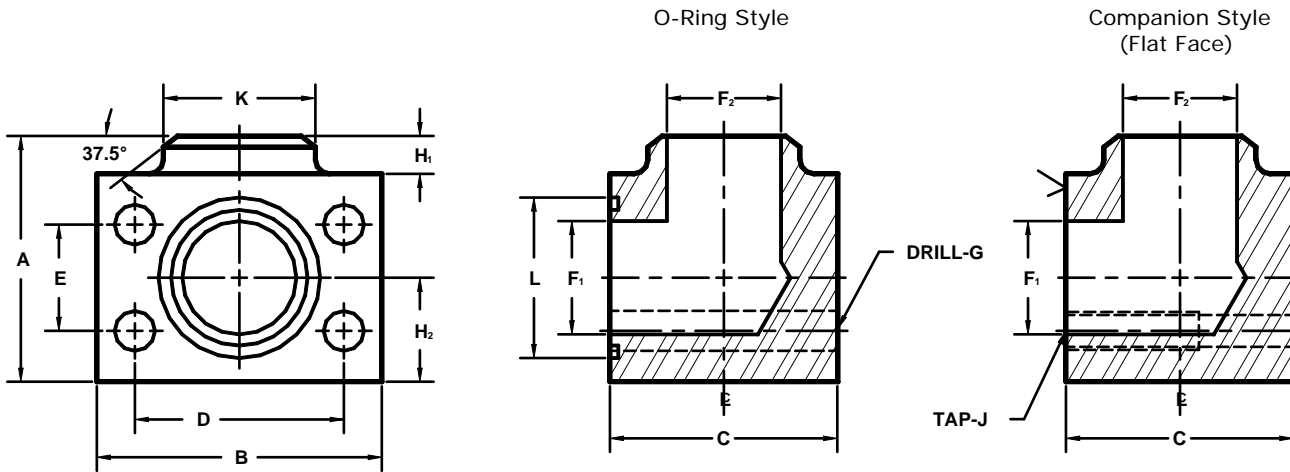

Model 1141

Model 1142

FLANGE SIZE	PIPE SIZE	PART NUMBER	A	B	C	D	E	F ₁	F ₂	G	H ₁	H ₂	J	K	L	MOUNTING KIT [ⓐ]		
																PART NO.	BOLT SIZE	O-RING
2	1 1/4	1141-32-20	3.75	4.00	3.40	3.062	1.688	1.94	1.16	.53	.50	1.62	----	1.75	2.500	MK 546	1/2-13 X 4 1/2	228
		1142-32-20	3.75	4.00	3.40	3.062	1.688	1.94	1.16	---	.50	1.62	1/2-13	1.75	----	-----	----	
2	1 1/2	1141-32-24	3.75	4.00	3.40	3.062	1.688	1.94	1.34	.53	.50	1.62	----	2.00	2.500	MK 546	1/2-13 X 4 1/2	228
		1142-32-24	3.75	4.00	3.40	3.062	1.688	1.94	1.34	---	.50	1.62	1/2-13	2.00	----	-----	----	
2	2	1141-32-32	3.75	4.00	3.40	3.062	1.688	1.94	1.69	.53	.50	1.62	----	2.50	2.500	MK 546	1/2-13 X 4 1/2	228
		1142-32-32	3.75	4.00	3.40	3.062	1.688	1.94	1.69	---	.50	1.62	1/2-13	2.50	----	-----	----	
2 1/2 [ⓐ]	1 1/2	1141-40-24	4.50	4.50	3.96	3.500	2.000	2.44	1.34	.53	.50	2.00	----	2.00	3.000	MK 547	1/2-13 X 5	232
		1142-40-24	4.50	4.50	3.96	3.500	2.000	2.44	1.34	---	.50	2.00	1/2-13	2.00	----	-----	----	
2 1/2 [ⓐ]	2	1141-40-32	4.50	4.50	3.96	3.500	2.000	2.44	1.69	.53	.50	2.00	----	2.50	3.000	MK 547	1/2-13 X 5	232
		1142-40-32	4.50	4.50	3.96	3.500	2.000	2.44	1.69	---	.50	2.00	1/2-13	2.50	----	-----	----	
2 1/2 [ⓐ]	2 1/2	1141-40-40	4.50	4.50	3.96	3.500	2.000	2.44	2.12	.53	.50	2.00	----	3.00	3.000	MK 547	1/2-13 X 5	232
		1142-40-40	4.50	4.50	3.96	3.500	2.000	2.44	2.12	---	.50	2.00	1/2-13	3.00	----	-----	----	
3 [ⓐ]	2	1141-48-32	5.00	5.31	4.96	4.188	2.438	2.94	1.69	.66	.50	2.25	----	2.50	3.625	MK 548	5/8-11 X 6	237
		1142-48-32	5.00	5.31	4.96	4.188	2.438	2.94	1.69	---	.50	2.25	5/8-11	2.50	----	-----	----	
3 [ⓐ]	2 1/2	1141-48-40	5.00	5.31	4.96	4.188	2.438	2.94	2.12	.66	.50	2.25	----	3.00	3.625	MK 548	5/8-11 X 6	237
		1142-48-40	5.00	5.31	4.96	4.188	2.438	2.94	2.12	---	.50	2.25	5/8-11	3.00	----	-----	----	
3 [ⓐ]	3	1141-48-48	5.00	5.31	4.96	4.188	2.438	2.94	2.62	.66	.50	2.25	----	3.50	3.625	MK 548	5/8-11 X 6	237
		1142-48-48	5.00	5.31	4.96	4.188	2.438	2.94	2.62	---	.50	2.25	5/8-11	3.50	----	-----	----	
3 1/2 [ⓐ]	2 1/2	1141-56-40	5.50	6.00	5.40	4.750	2.750	3.44	2.12	.66	.50	2.50	----	3.00	4.109	MK 549	5/8-11 X 6 1/2	241
		1142-56-40	5.50	6.00	5.40	4.750	2.750	3.44	2.12	---	.50	2.50	5/8-11	3.00	----	-----	----	
3 1/2 [ⓐ]	3	1141-56-48	5.50	6.00	5.40	4.750	2.750	3.44	2.62	.66	.50	2.50	----	3.50	4.109	MK 549	5/8-11 X 6 1/2	241
		1142-56-48	5.50	6.00	5.40	4.750	2.750	3.44	2.62	---	.50	2.50	5/8-11	3.50	----	-----	----	
3 1/2 [ⓐ]	3 1/2	1141-56-56	5.50	6.00	5.40	4.750	2.750	3.44	3.00	.66	.50	2.50	----	4.00	4.109	MK 549	5/8-11 X 6 1/2	241
		1142-56-56	5.50	6.00	5.40	4.750	2.750	3.44	3.00	---	.50	2.50	5/8-11	4.00	----	-----	----	
4 [ⓐ]	3	1141-64-48	6.00	6.38	5.96	5.125	3.062	3.94	2.62	.66	.50	2.75	----	3.50	4.609	MK 550	5/8-11 X 7	245
		1142-64-48	6.00	6.38	5.96	5.125	3.062	3.94	2.62	---	.50	2.75	5/8-11	3.50	----	-----	----	
4 [ⓐ]	4	1141-64-64	6.00	6.38	5.96	5.125	3.062	3.94	3.44	.66	.50	2.75	----	4.50	4.609	MK 550	5/8-11 X 7	245
		1142-64-64	6.00	6.38	5.96	5.125	3.062	3.94	3.44	---	.50	2.75	5/8-11	4.50	----	-----	----	

ⓐ Order Separately ⓑ 2500 PSI Max ⓒ 2000 PSI Max ⓓ 500 PSI Max

MATERIAL : STEEL
1/07