

Developers and Manufacturers of Hydraulic Flanges & Components

## NPTF THREADED IN-LINE PIPE FLANGES

SAE BOLT PATTERN

61 SERIES

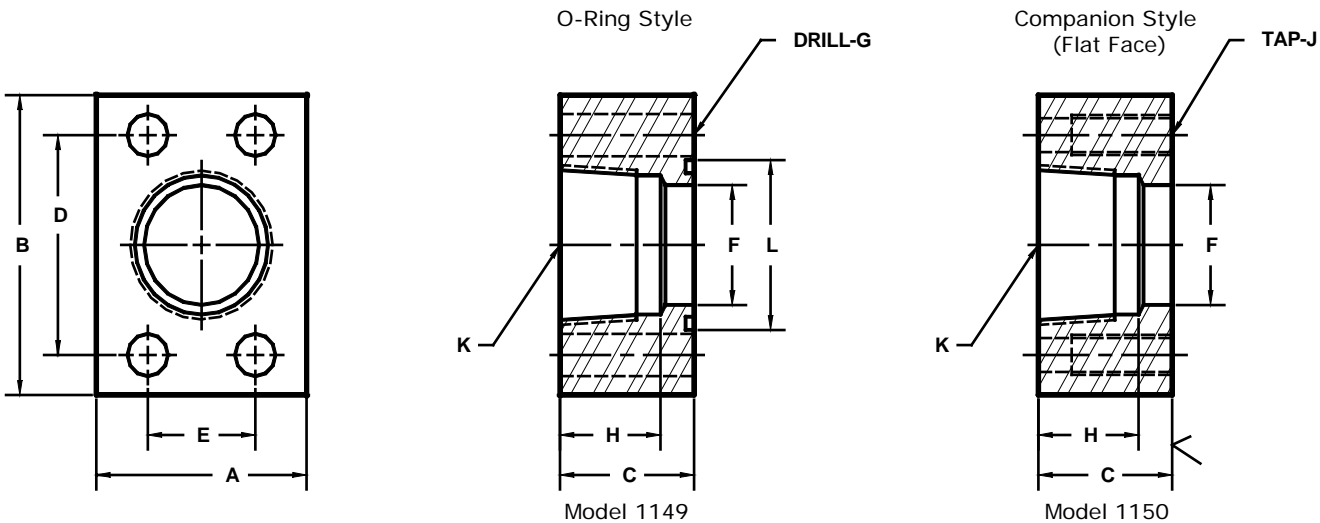

FLANGE SIZE	PIPE SIZE	PART NUMBER	A	B	C	D	E	F	G	H	J	K	L	MOUNTING KIT <sup>①</sup>		
														PART NO.	BOLT SIZE	O-RING
1/2	1/2	1149-08-08	1.50	2.12	1.25	1.500	.688	.50	.34	1.06	-----	1/2	1.000	MK 519	5/16-18 X 1 3/4	210
		1150-08-08							---				5/16-18	---		
1/2	3/4	-----	1.75	2.12	2.50	1.500	.688	.50	---	1.06	-----	3/4	---	-----	-----	---
		1150-08-12							---				5/16-18	---		
3/4	1/2	1149-12-08	1.75	2.62	1.25	1.875	.875	.70	.41	NA	-----	1/2	1.250	MK 520	3/8-16 X 2	214
		1150-12-08							---				3/8-16	---		
3/4	3/4	1149-12-12	1.75	2.62	1.25	1.875	.875	.75	.41	1.06	-----	3/4	1.250	MK 520	3/8-16 X 2	214
		1150-12-12							---				3/8-16	---		
3/4	1	-----	2.00	2.62	2.50	1.875	.875	.75	---	1.25	-----	1	---	-----	-----	---
		1150-12-16							---				3/8-16	---		
1	3/4	1149-16-12	2.00	2.82	1.50	2.062	1.031	.92	.41	NA	-----	3/4	1.562	MK 521	3/8-16 X 2 1/4	219
		1150-16-12							---				3/8-16	---		
1	1	1149-16-16	2.00	2.82	1.50	2.062	1.031	1.00	.41	1.25	-----	1	1.562	MK 521	3/8-16 X 2 1/4	219
		1150-16-16							---				3/8-16	---		
1	1 1/4	-----	2.50	2.82	3.00	2.062	1.031	1.00	---	1.31	-----	1 1/4	---	-----	-----	---
		1150-16-20							---				3/8-16	---		
1 1/4	1	1149-20-16	2.50	3.19	1.50	2.312	1.188	1.16	.47	NA	-----	1	1.750	MK 522	7/16-14 X 2 1/4	222
		1150-20-16							---				7/16-14	---		
1 1/4	1 1/4	1149-20-20	2.50	3.19	1.50	2.312	1.188	1.25	.47	1.31	-----	1 1/4	1.750	MK 522	7/16-14 X 2 1/4	222
		1150-20-20							---				7/16-14	---		
1 1/4	1 1/2	-----	3.00	3.19	3.00	2.312	1.188	1.25	---	1.31	-----	1 1/2	---	-----	-----	---
		1150-20-24							---				7/16-14	---		
1 1/2	1 1/4	1149-24-20	2.75	3.75	1.75	2.750	1.406	1.50	.53	NA	-----	1 1/4	2.125	MK 523	1/2-13 X 2 1/2	225
		1150-24-20							---				1/2-13	---		
1 1/2	1 1/2	1149-24-24	2.75	3.75	1.75	2.750	1.406	1.50	.53	1.31	-----	1 1/2	2.125	MK 523	1/2-13 X 2 1/2	225
		1150-24-24							---				1/2-13	---		
1 1/2	2	-----	3.50	3.75	3.50	2.750	1.406	1.50	---	1.31	-----	2	---	-----	-----	---
		1150-24-32							---				1/2-13	---		

① Order Separately

MATERIAL : STEEL  
1/07

Developers and Manufacturers of Hydraulic Flanges & Components

## NPTF THREADED IN-LINE PIPE FLANGES

SAE BOLT PATTERN

61 SERIES

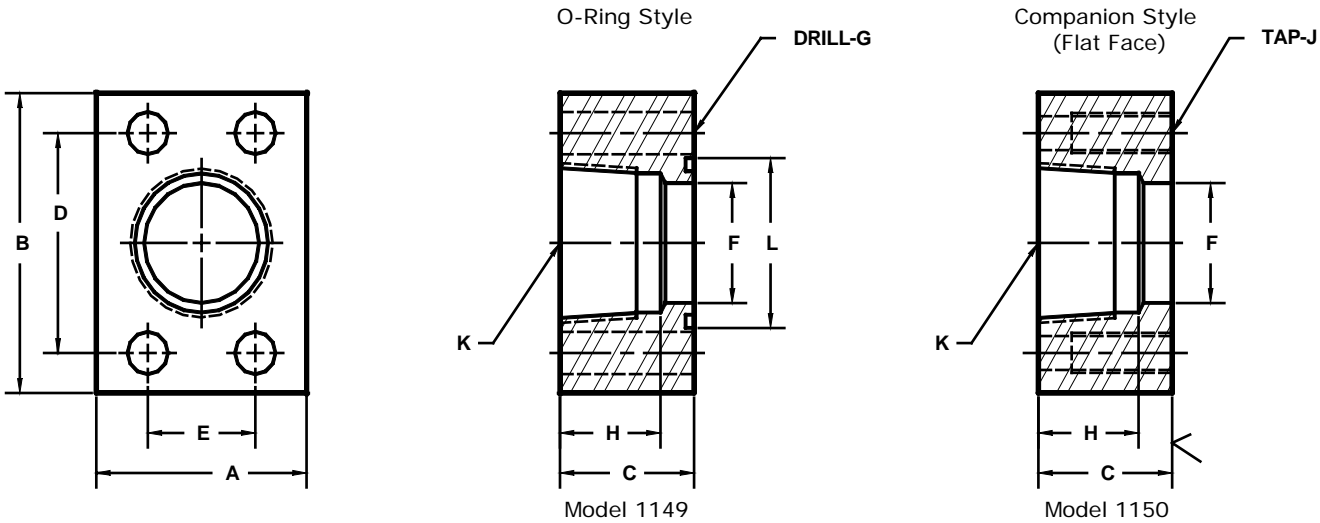

FLANGE SIZE	PIPE SIZE	PART NUMBER	A	B	C	D	E	F	G	H	J	K	L	MOUNTING KIT <sup>①</sup>		
														PART NO.	BOLT SIZE	O-RING
2	1 1/4	1149-32-20	3.25	4.00	1.75	3.062	1.688	1.50	.53	NA	----	1 1/4	2.500	MK 524	1/2-13 X 2 1/2	228
		1150-32-20							---	1/2-13	---		---			
2	1 1/2	1149-32-24	3.25	4.00	1.75	3.062	1.688	1.74	.53	NA	----	1 1/2	2.500	MK 524	1/2-13 X 2 1/2	228
		1150-32-24							---	1/2-13	---		---			
2	2	1149-32-32	3.25	4.00	1.75	3.062	1.688	1.94	.53	1.31	----	2	2.500	MK 524	1/2-13 X 2 1/2	228
		1150-32-32							---	1/2-13	---		---			
2 1/2 <sup>②</sup>	1 1/2	1149-40-24	4.00	4.50	2.00	3.500	2.000	1.74	.53	NA	----	1 1/2	3.000	MK 1515	1/2-13 X 2 3/4	232
		1150-40-24							---	1/2-13	---		---			
2 1/2 <sup>②</sup>	2	1149-40-32	4.00	4.50	2.00	3.500	2.000	2.12	.53	NA	----	2	3.000	MK 1515	1/2-13 X 2 3/4	232
		1150-40-32							---	1/2-13	---		---			
2 1/2 <sup>②</sup>	2 1/2	1149-40-40	4.00	4.50	2.00	3.500	2.000	2.44	.53	1.59	----	2 1/2	3.000	MK 1515	1/2-13 X 2 3/4	232
		1150-40-40							---	1/2-13	---		---			
3 <sup>③</sup>	2	1149-48-32	4.50	5.50	2.25	4.188	2.438	2.12	.66	NA	----	2	3.625	MK 1516	5/8-11 X 3 1/2	237
		1150-48-32							---	5/8-11	---		---			
3 <sup>③</sup>	2 1/2	1149-48-40	4.50	5.50	2.25	4.188	2.438	2.62	.66	NA	----	2 1/2	3.625	MK 1516	5/8-11 X 3 1/2	237
		1150-48-40							---	5/8-11	---		---			
3 <sup>③</sup>	3	1149-48-48	4.50	5.50	2.25	4.188	2.438	2.94	.66	1.91	----	3	3.625	MK 1516	5/8-11 X 3 1/2	237
		1150-48-48							---	5/8-11	---		---			
3 1/2 <sup>④</sup>	2 1/2	1149-56-40	5.00	6.00	1.50	4.750	2.750	2.62	.66	NA	----	2 1/2	4.109	MK 509	5/8-11 X 2 1/2	241
		1150-56-40							---	5/8-11	---		---			
3 1/2 <sup>④</sup>	3	1149-56-48	5.00	6.00	1.50	4.750	2.750	3.20	.66	NA	----	3	4.109	MK 509	5/8-11 X 2 1/2	241
		1150-56-48							---	5/8-11	---		---			
3 1/2 <sup>④</sup>	3 1/2	1149-56-56	5.00	6.00	2.25	4.750	2.750	3.44	.66	1.91	----	3 1/2	4.109	MK 2576	5/8-11 X 3 1/2	241
		1150-56-56							---	5/8-11	---		---			
4 <sup>④</sup>	3	1149-64-48	5.50	6.38	1.50	5.125	3.062	3.20	.66	NA	----	3	4.609	MK 510	5/8-11 X 2 1/2	245
		1150-64-48							---	5/8-11	---		---			
4 <sup>④</sup>	4	1149-64-64	5.50	6.50	2.50	5.125	3.062	3.94	.66	2.06	----	4	4.609	MK 2545	5/8-11 X 3 1/2	245
		1150-64-64							---	5/8-11	---		---			

① Order Separately    ② 2500 PSI Max    ③ 2000 PSI Max    ④ 500 PSI Max

MATERIAL : STEEL  
1/07