

Developers and Manufacturers of Hydraulic Flanges & Components

## SAE STRAIGHT THREADED IN-LINE FLANGES

SAE BOLT PATTERN

62 SERIES

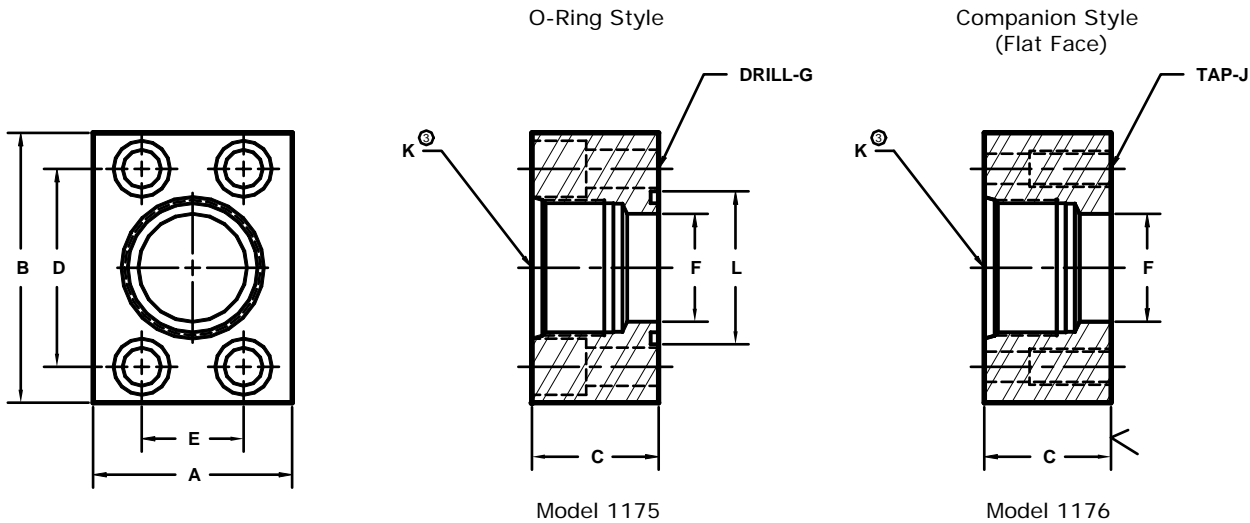

FLANGE SIZE	PORT SIZE	PART NUMBER	A	B	C	D	E	F	G	J	K	L	MOUNTING KIT <sup>ⓐ</sup>		
													PART NO.	BOLT SIZE	O-RING
1/2	-6	1175-08-06	1.75	2.22	1.25	1.594	.718	.47	.34	----	9/16-18	1.000	MK 501	5/16-18 X 1 1/4	210
		---							5/16-18	---					
1/2	-8	1175-08-08	1.75	2.22	1.25	1.594	.718	.50	.34	----	3/4-16	1.000	MK 501	5/16-18 X 1 1/4	210
		---							5/16-18	---					
3/4	-8	1175-12-08	2.00	2.81	1.50	2.000	.937	.66	.41	----	3/4-16	1.250	MK 1525	3/8-16 X 1 1/2	214
		---							3/8-16	---					
3/4	-10	1175-12-10	2.00	2.81	1.50	2.000	.937	.50	.41	----	7/8-14	1.250	MK 1525	3/8-16 X 1 1/2	214
		---							3/8-16	---					
3/4	-12	1175-12-12	2.00	2.81	1.50	2.000	.937	.75	.41	----	1 1/16-12	1.250	MK 1525	3/8-16 X 1 1/2	214
		---							3/8-16	---					
1	-12	1175-16-12	2.25	3.19	1.50	2.250	1.093	.94	.47	----	1 1/16-12	1.562	MK 1529	7/16-14 X 1 1/2	219
		---							7/16-14	---					
1	-14	1175-16-14	2.25	3.19	1.50	2.250	1.093	.75	.47	----	1 3/16-12	1.562	MK 1529	7/16-14 X 1 1/2	219
		---							7/16-14	---					
1	-16	1175-16-16	2.25	3.19	1.50	2.250	1.093	1.00	.47	----	1 5/16-12	1.562	MK 1529	7/16-14 X 1 1/2	219
		---							7/16-14	---					
1 1/4	-16	1175-20-16	3.00	3.75	1.50	2.625	1.250	1.20	.53	----	1 5/16-12	1.750	MK 1523	1/2-13 X 1 1/2	222
		---							1/2-13	---					
1 1/4	-20	1175-20-20	3.00	3.75	1.50	2.625	1.250	1.25	.53	----	1 5/8-12	1.750	MK 1523	1/2-13 X 1 1/2	222
		---							1/2-13	---					
1 1/2	-20	1175-24-20	3.25	4.50	1.75	3.125	1.437	1.50	.66	----	1 5/8-12	2.125	MK 1544	5/8-11 X 1 3/4	225
		---							5/8-11	---					
1 1/2	-24	1175-24-24	3.25	4.50	1.75	3.125	1.437	1.50	.66	----	1 7/8-12	2.125	MK 1544	5/8-11 X 1 3/4	225
		---							5/8-11	---					
2	-24	1175-32-24	4.00	5.25	1.75	3.812	1.750	1.77	.78	----	1 7/8-12	2.500	MK 563	3/4-10 X 2	228
		---							3/4-10	---					
2	-32	1175-32-32	4.00	5.25	1.75	3.812	1.750	1.94	.78	----	2 1/2-12	2.500	MK 563	3/4-10 X 2	228
		---							3/4-10	---					

ⓐ Order Separately

ⓑ The pressure rating of the assembly should not exceed the lower of the flange pad or the fitting. Check the fitting manufacturer for details.

MATERIAL : STEEL  
1/07