

Developers and Manufacturers of Hydraulic Flanges & Components

SAE STRAIGHT THREADED IN-LINE FLANGES

ISO 6162-2 PATTERN / J518 62 SERIES METRIC

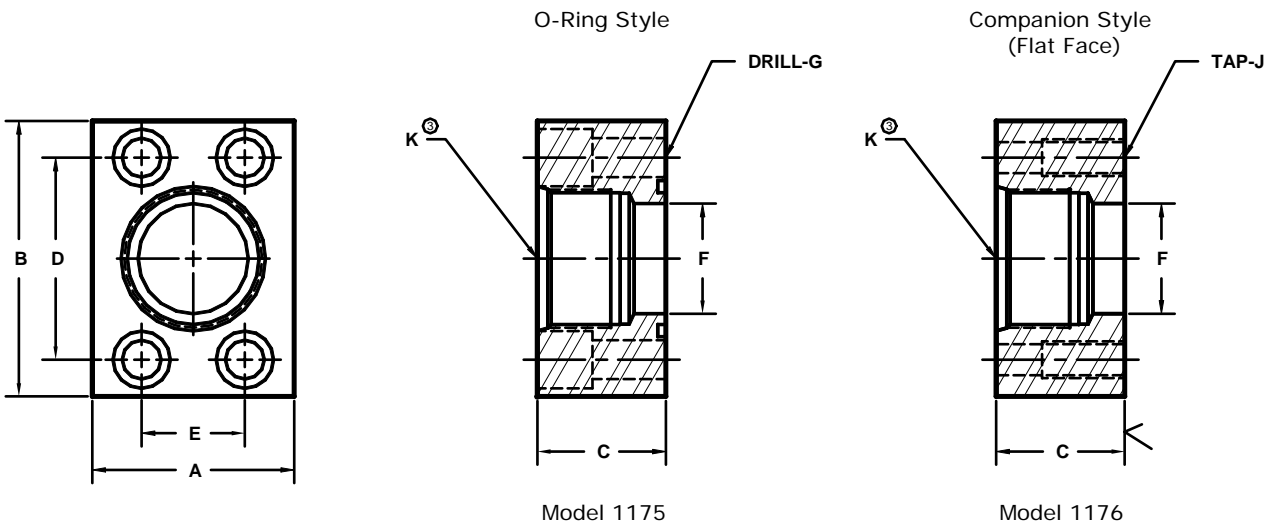

| FLANGE SIZE | PORT SIZE | PART NUMBER | A | B | C | D | E | F | G | J | K | MOUNTING KIT ^① | | |
|-------------|-----------|----------------|-------|-------|------|---------|---------|------|------|------------|-----------|---------------------------|-----------|--------|
| | | | | | | | | | | | | PART NO. | BOLT SIZE | O-RING |
| 13 | 1/2 | -6 | 44.5 | 56.5 | 31.5 | 40.49 | 18.24 | 11.9 | 8.5 | ---- | 9/16-18 | MKM 501 | M8 x 30 | 210 |
| | | 1175-08-06M8 | | | | (1.594) | (.718) | | --- | M8 x 1.25 | | ----- | --- | |
| 13 | 1/2 | -8 | 44.5 | 56.5 | 31.5 | 40.49 | 18.24 | 12.5 | 8.5 | ---- | 3/4-16 | MKM 501 | M8 x 30 | 210 |
| | | 1175-08-08M8 | | | | (1.594) | (.718) | | --- | M8 x 1.25 | | ----- | --- | |
| 19 | 3/4 | -8 | 51.0 | 71.5 | 38.0 | 50.80 | 23.80 | 16.7 | 10.5 | ---- | 3/4-16 | MKM 1525 | M10 x 35 | 214 |
| | | 1175-12-08M10 | | | | (2.000) | (.937) | | --- | M10 x 1.5 | | ----- | --- | |
| 19 | 3/4 | -12 | 51.0 | 71.5 | 38.0 | 50.80 | 23.80 | 19.0 | 10.5 | ---- | 1 1/16-12 | MKM 1525 | M10 x 35 | 214 |
| | | 1175-12-12M10 | | | | (2.000) | (.937) | | --- | M10 x 1.5 | | ----- | --- | |
| 25 | 1 | -12 | 57.0 | 81.0 | 38.0 | 57.15 | 27.76 | 23.8 | 12.5 | ---- | 1 1/16-12 | MKM 1529 | M12 x 40 | 219 |
| | | 1175-16-12M12 | | | | (2.250) | (1.093) | | --- | M12 x 1.75 | | ----- | --- | |
| 25 | 1 | -16 | 57.0 | 81.0 | 38.0 | 57.15 | 27.76 | 25.0 | 12.5 | ---- | 1 5/16-12 | MKM 1529 | M12 x 40 | 219 |
| | | 1175-16-16M12 | | | | (2.250) | (1.093) | | --- | M12 x 1.75 | | ----- | --- | |
| 32 | 1 1/4 | -16 | 76.0 | 95.5 | 38.0 | 66.68 | 31.75 | 30.4 | 13.0 | ---- | 1 5/16-12 | MKM 567 | M12 x 35 | 222 |
| | | 1175-20-16M12 | | | | (2.625) | (1.250) | | --- | M12 x 1.75 | | ----- | --- | |
| 32 | 1 1/4 | -16 | 76.0 | 95.5 | 38.0 | 66.68 | 31.75 | 30.4 | 15.0 | ---- | 1 5/16-12 | MKM 1523 | M14 x 40 | 222 |
| | | 1175-20-16M14* | | | | (2.625) | (1.250) | | --- | M14 x 2 | | ----- | --- | |
| 32 | 1 1/4 | -20 | 76.0 | 95.5 | 38.0 | 66.68 | 31.75 | 31.5 | 13.0 | ---- | 1 5/8-12 | MKM 567 | M12 x 35 | 222 |
| | | 1175-20-20M12 | | | | (2.625) | (1.250) | | --- | M12 x 1.75 | | ----- | --- | |
| 32 | 1 1/4 | -20 | 76.0 | 95.5 | 38.0 | 66.68 | 31.75 | 31.5 | 15.0 | ---- | 1 5/8-12 | MKM 1523 | M14 x 40 | 222 |
| | | 1175-20-20M14* | | | | (2.625) | (1.250) | | --- | M14 x 2 | | ----- | --- | |
| 38 | 1 1/2 | -20 | 82.5 | 114.5 | 44.0 | 79.38 | 36.50 | 38.0 | 17.0 | ---- | 1 5/8-12 | MKM 1544 | M16 x 45 | 225 |
| | | 1175-24-20M16 | | | | (3.125) | (1.437) | | --- | M16 x 2 | | ----- | --- | |
| 38 | 1 1/2 | -24 | 82.5 | 114.5 | 44.0 | 79.38 | 36.50 | 38.0 | 17.0 | ---- | 1 7/8-12 | MKM 1544 | M16 x 45 | 225 |
| | | 1175-24-24M16 | | | | (3.125) | (1.437) | | --- | M16 x 2 | | ----- | --- | |
| 51 | 2 | -32 | 101.5 | 133.5 | 44.0 | 96.82 | 44.45 | 49.2 | 21.0 | ---- | 2 1/2-12 | MKM 563 | M20 x 45 | 228 |
| | | 1175-32-32M20 | | | | (3.812) | (1.750) | | --- | M20 x 2.5 | | ----- | --- | |

① Order Separately

③ The pressure rating of the assembly should not exceed the lower of the flange pad or the fitting. Check the fitting manufacturer for details.

MATERIAL : STEEL
1/07

NOTE: DIMENSIONS ARE IN MILLIMETERS. INCH EQUIVALENTS IN ().