

Developers and Manufacturers of Hydraulic Flanges & Components

SAE STRAIGHT THREADED ELBOW FLANGES

ISO 6162-1 PATTERN / J518 61 SERIES METRIC

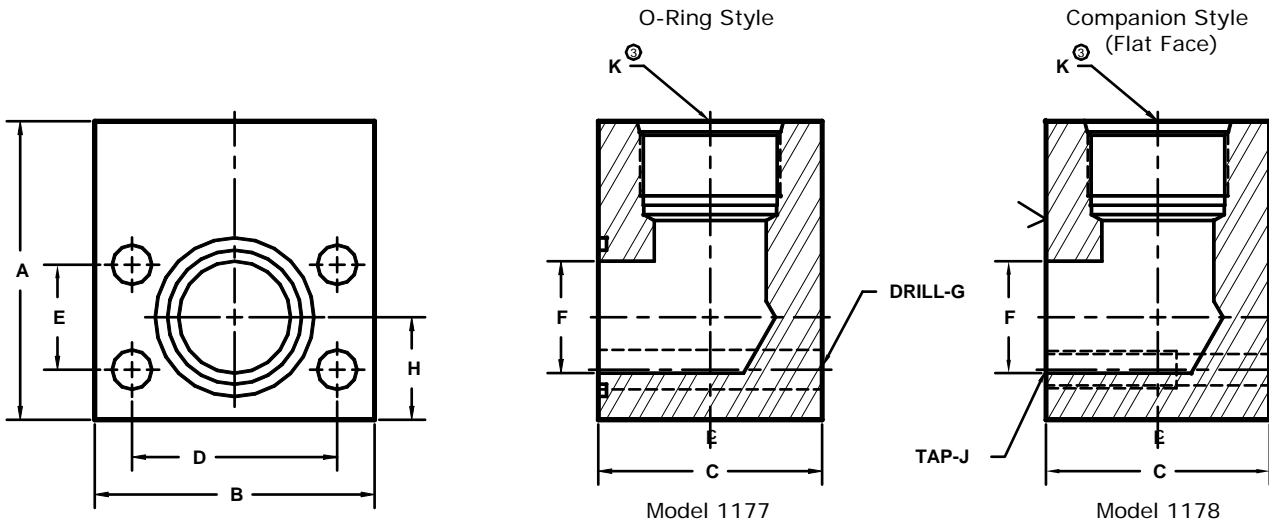

FLANGE SIZE	PORT SIZE	PART NUMBER	A	B	C	D	E	F	G	H	J	K	MOUNTING KIT ^①		
													PART NO.	BOLT SIZE	O-RING
13	1/2	1177-08-04M8	51.0	54.0	36.5	38.10 (1.500)	17.48 (.688)	12.5	8.5	19.0	----- M8 x 1.25	7/16-20	MKM 541	M8 x 50	210
		1178-08-04M8											-----	-----	---
13	1/2	1177-08-06M8	51.0	54.0	36.5	38.10 (1.500)	17.48 (.688)	12.5	8.5	19.0	----- M8 x 1.25	9/16-18	MKM 541	M8 x 50	210
		1178-08-06M8											-----	-----	---
13	1/2	1177-08-08M8	51.0	54.0	36.5	38.10 (1.500)	17.48 (.688)	12.5	8.5	19.0	----- M8 x 1.25	3/4-16	MKM 541	M8 x 50	210
		1178-08-08M8											-----	-----	---
19	3/4	1177-12-08M10	63.5	66.5	43.0	47.63 (1.875)	22.23 (.875)	19.0	10.5	22.4	----- M10 x 1.5	3/4-16	MKM 542	M10 x 60	214
		1178-12-08M10											-----	-----	---
19	3/4	1177-12-12M10	63.5	66.5	43.0	47.63 (1.875)	22.23 (.875)	19.0	10.5	22.4	----- M10 x 1.5	1 1/16-12	MKM 542	M10 x 60	214
		1178-12-12M10											-----	-----	---
25	1	1177-16-10M10	76.0	71.5	49.5	52.37 (2.062)	26.19 (1.031)	25.0	10.5	25.4	----- M10 x 1.5	7/8-14	MKM 543	M10 x 65	219
		1178-16-10M10											-----	-----	---
25	1	1177-16-12M10	76.0	71.5	49.5	52.37 (2.062)	26.19 (1.031)	25.0	10.5	25.4	----- M10 x 1.5	1 1/16-12	MKM 543	M10 x 65	219
		1178-16-12M10											-----	-----	---
25	1	1177-16-14M10	76.0	71.5	49.5	52.37 (2.062)	26.19 (1.031)	25.0	10.5	25.4	----- M10 x 1.5	1 3/16-12	MKM 543	M10 x 65	219
		1178-16-14M10											-----	-----	---
25	1	1177-16-16M10	76.0	71.5	49.5	52.37 (2.062)	26.19 (1.031)	25.0	10.5	25.4	----- M10 x 1.5	1 5/16-12	MKM 543	M10 x 65	219
		1178-16-16M10											-----	-----	---
32	1 1/4	1177-20-16M10	89.0	81.0	61.0	58.72 (2.312)	30.18 (1.188)	31.5	10.5	31.8	----- M10 x 1.5	1 5/16-12	MKM 4532	M10 x 75	222
		1178-20-16M10											-----	-----	---
32	1 1/4	1177-20-16M12*	89.0	81.0	61.0	58.72 (2.312)	30.18 (1.188)	31.5	12.5	31.8	----- M12 x 1.75	1 5/16-12	MKM 578	M12 x 80	222
		1178-20-16M12*											-----	-----	---
32	1 1/4	1177-20-20M10	89.0	81.0	61.0	58.72 (2.312)	30.18 (1.188)	31.5	10.5	31.8	----- M10 x 1.5	1 5/8-12	MKM 4532	M10 x 75	222
		1178-20-20M10											-----	-----	---
32	1 1/4	1177-20-20M12*	89.0	81.0	61.0	58.72 (2.312)	30.18 (1.188)	31.5	12.5	31.8	----- M12 x 1.75	1 5/8-12	MKM 578	M12 x 80	222
		1178-20-20M12*											-----	-----	---

① Order Separately ③ The pressure rating of the assembly should not exceed the lower of the flange pad or the fitting. Check the fitting manufacturer for details. MATERIAL : STEEL
 * Non Standard Bolt For This Flange Size. NOTE: DIMENSIONS ARE IN MILLIMETERS. INCH EQUIVALENTS IN (). 1/07

Developers and Manufacturers of Hydraulic Flanges & Components

SAE STRAIGHT THREADED ELBOW FLANGES

ISO 6162-1 PATTERN / J518 61 SERIES METRIC

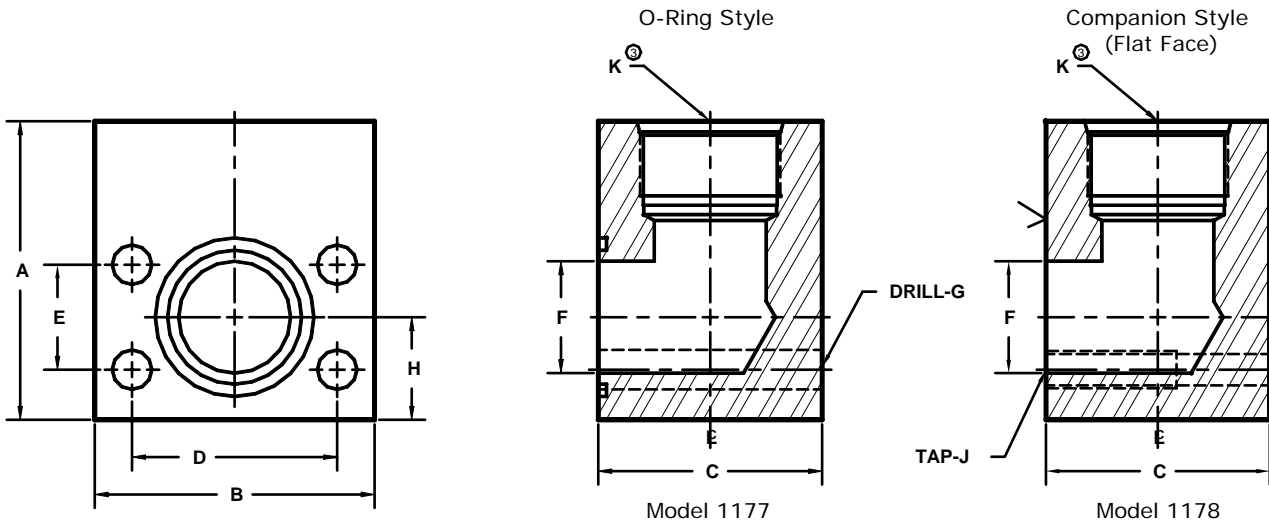

FLANGE SIZE	PORT SIZE	PART NUMBER	A	B	C	D	E	F	G	H	J	K	MOUNTING KIT ^①		
													PART NO.	BOLT SIZE	O-RING
38	1½	-20	101.5	95.5	73.5	69.85 (2.750)	35.71 (1.406)	38.0	13.0	35.1	----- M12 x 1.75	1 5/8-12	MKM 4533	M12 x 90	225
													-----	-----	---
38	1½	-20	101.5	95.5	73.5	69.85 (2.750)	35.71 (1.406)	38.0	15.0	35.1	----- M14 x 2	1 5/8-12	MKM 545	M14 x 100	225
													-----	-----	---
38	1½	-24	101.5	95.5	73.5	69.85 (2.750)	35.71 (1.406)	38.0	13.0	35.1	----- M12 x 1.75	1 7/8-12	MKM 4533	M12 x 90	225
													-----	-----	---
38	1½	-24	101.5	95.5	73.5	69.85 (2.750)	35.71 (1.406)	38.0	15.0	35.1	----- M14 x 2	1 7/8-12	MKM 545	M14 x 100	225
													-----	-----	---
51	2	-24	114.0	101.5	73.5	77.77 (3.062)	42.88 (1.688)	49.2	13.0	41.1	----- M12 x 1.75	1 7/8-12	MKM 4547	M12 x 90	228
													-----	-----	---
51	2	-24	114.0	101.5	73.5	77.77 (3.062)	42.88 (1.688)	49.2	15.0	41.1	----- M14 x 2	1 7/8-12	MKM 558	M14 x 100	228
													-----	-----	---
51	2	-32	108.0	101.5	100.0	77.77 (3.062)	42.88 (1.688)	49.2	13.0	41.1	----- M12 x 1.75	2 1/2-12	MKM 3550	M12 x 120	228
													-----	-----	---
51	2	-32	108.0	101.5	100.0	77.77 (3.062)	42.88 (1.688)	49.2	15.0	41.1	----- M14 x 2	2 1/2-12	MKM 592	M14 x 120	228
													-----	-----	---
64 ^②	2½	-24	127.0	114.0	100.0	88.90 (3.500)	50.80 (2.000)	62.0	13.0	50.8	----- M12 x 1.75	1 7/8-12	MKM 4535	M12 x 120	232
													-----	-----	---
64 ^②	2½	-24	127.0	114.0	100.0	88.90 (3.500)	50.80 (2.000)	62.0	15.0	50.8	----- M14 x 2	1 7/8-12	MKM 547	M14 x 120	232
													-----	-----	---
64 ^②	2½	-32	127.0	114.0	100.0	88.90 (3.500)	50.80 (2.000)	62.0	13.0	50.8	----- M12 x 1.75	2 1/2-12	MKM 4535	M12 x 120	232
													-----	-----	---
64 ^②	2½	-32	127.0	114.0	100.0	88.90 (3.500)	50.80 (2.000)	62.0	15.0	50.8	----- M14 x 2	2 1/2-12	MKM 547	M14 x 120	232
													-----	-----	---

① Order Separately ② 16 MPa Max ③ The pressure rating of the assembly should not exceed the lower of the flange pad or the fitting. MATERIAL : STEEL
 * Non Standard Bolt For This Flange Size. flange pad or the fitting. Check the fitting manufacturer for details. 1/07
 NOTE: DIMENSIONS ARE IN MILLIMETERS. INCH EQUIVALENTS IN ().