

Developers and Manufacturers of Hydraulic Flanges & Components

## SAE STRAIGHT THREADED ELBOW FLANGES

SAE BOLT PATTERN

62 SERIES

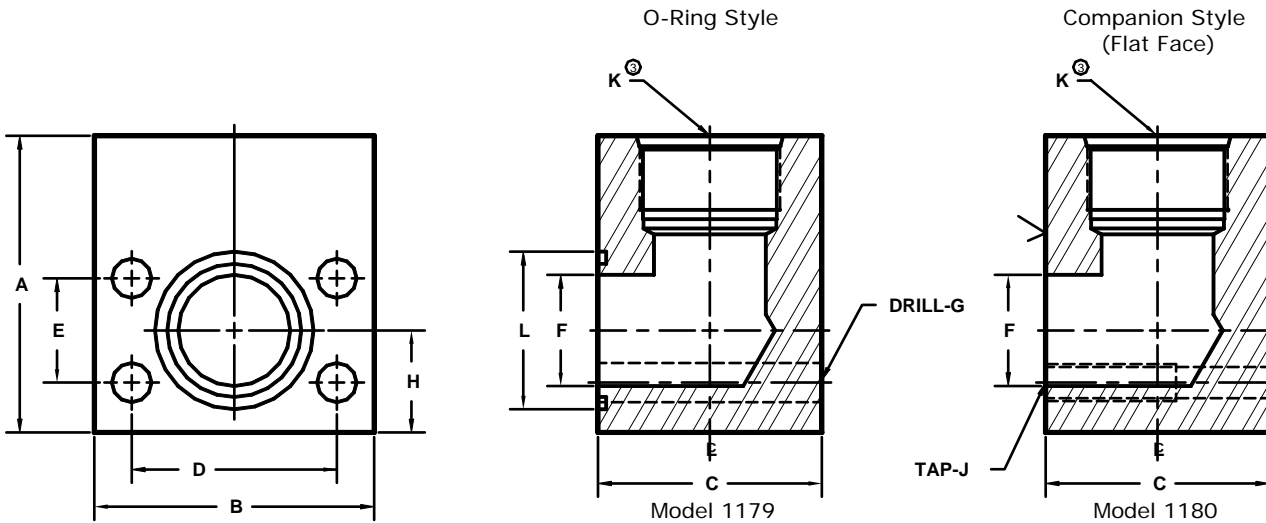

FLANGE SIZE	PORT SIZE	PART NUMBER	A	B	C	D	E	F	G	H	J	K	L	MOUNTING KIT <sup>ⓐ</sup>		
														PART NO.	BOLT SIZE	O-RING
1/2	-6	1179-08-06	2.00	2.22	1.46	1.594	.718	.50	.34	.88	-----	9/16-18	1.000	MK 541	5/16-18 X 2	210
		1180-08-06							---				5/16-18	-----	---	
1/2	-8	1179-08-08	2.00	2.22	1.46	1.594	.718	.50	.34	.88	-----	3/4-16	1.000	MK 541	5/16-18 X 2	210
		1180-08-08							---				5/16-18	-----	---	
3/4	-8	1179-12-08	2.50	2.81	1.70	2.000	.937	.75	.41	1.00	-----	3/4-16	1.250	MK 542	3/8-16 X 2 1/2	214
		1180-12-08							---				3/8-16	-----	---	
3/4	-10	1179-12-10	2.50	2.81	1.70	2.000	.937	.75	.41	1.00	-----	7/8-14	1.250	MK 542	3/8-16 X 2 1/2	214
		1180-12-10							---				3/8-16	-----	---	
3/4	-12	1179-12-12	2.50	2.81	1.70	2.000	.937	.75	.41	1.00	-----	1 1/16-12	1.250	MK 542	3/8-16 X 2 1/2	214
		1180-12-12							---				3/8-16	-----	---	
1	-12	1179-16-12	3.00	3.19	1.96	2.250	1.093	1.00	.47	1.12	-----	1 1/16-12	1.562	MK 551	7/16-14 X 2 3/4	219
		1180-16-12							---				7/16-14	-----	---	
1	-14	1179-16-14	3.00	3.19	1.96	2.250	1.093	1.00	.47	1.12	-----	1 3/16-12	1.562	MK 551	7/16-14 X 2 3/4	219
		1180-16-14							---				7/16-14	-----	---	
1	-16	1179-16-16	3.00	3.19	1.96	2.250	1.093	1.00	.47	1.12	-----	1 5/16-12	1.562	MK 551	7/16-14 X 2 3/4	219
		1180-16-16							---				7/16-14	-----	---	
1 1/4	-16	1179-20-16	4.00	3.75	2.40	2.625	1.250	1.25	.53	1.38	-----	1 5/16-12	1.750	MK 552	1/2-13 X 3 1/4	222
		1180-20-16							---				1/2-13	-----	---	
1 1/4	-20	1179-20-20	4.00	3.75	2.40	2.625	1.250	1.25	.53	1.38	-----	1 5/8-12	1.750	MK 552	1/2-13 X 3 1/4	222
		1180-20-20							---				1/2-13	-----	---	
1 1/2	-20	1179-24-20	4.00	4.50	2.96	3.125	1.437	1.50	.66	1.62	-----	1 5/8-12	2.125	MK 553	5/8-11 X 4	225
		1180-24-20							---				5/8-11	-----	---	
1 1/2	-24	1179-24-24	4.00	4.50	2.96	3.125	1.437	1.50	.66	1.62	-----	1 7/8-12	2.125	MK 553	5/8-11 X 4	225
		1180-24-24							---				5/8-11	-----	---	
2	-24	1179-32-24	5.00	5.25	3.46	3.812	1.750	1.94	.78	2.00	-----	1 7/8-12	2.500	MK 554	3/4-10 X 4 1/2	228
		1180-32-24							---				3/4-10	-----	---	
2	-32	1179-32-32	5.00	5.25	3.94	3.812	1.750	1.94	.78	2.00	-----	2 1/2-12	2.500	MK 1507	3/4-10 X 5	228
		1180-32-32							---				3/4-10	-----	---	

ⓐ Order Separately

ⓑ The pressure rating of the assembly should not exceed the lower of the flange pad or the fitting. Check the fitting manufacturer for details.

MATERIAL : STEEL  
1/07