

Developers and Manufacturers of Hydraulic Flanges & Components

## SAE STRAIGHT THREADED ELBOW FLANGES

ISO 6162-2 PATTERN / J518 62 SERIES METRIC

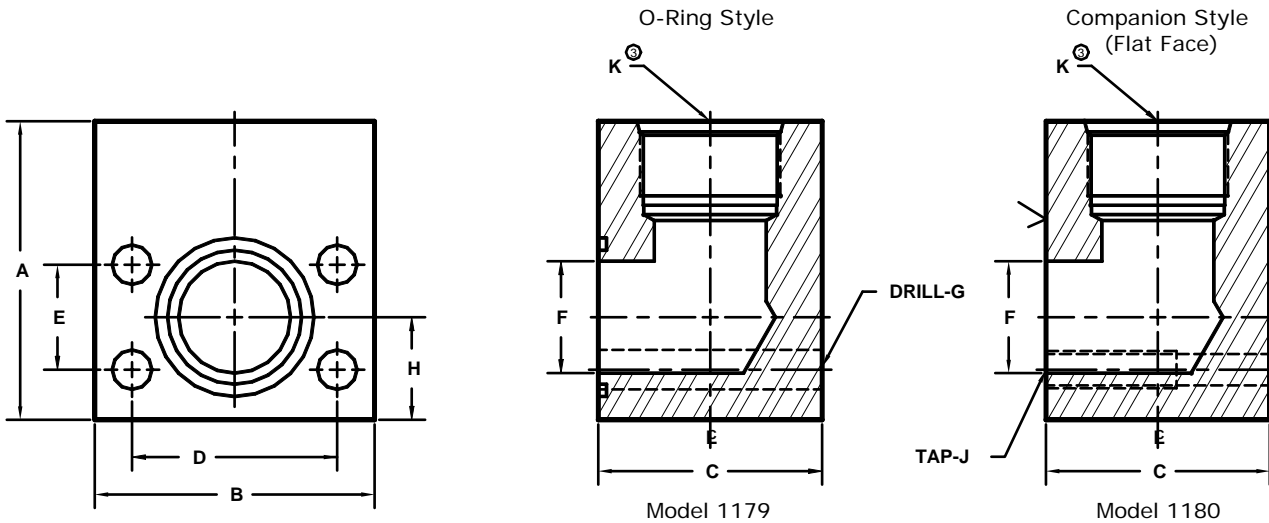

FLANGE SIZE	PORT SIZE	PART NUMBER	A	B	C	D	E	F	G	H	J	K	MOUNTING KIT <sup>①</sup>		
													PART NO.	BOLT SIZE	O-RING
13	1/2	-6	51.0	56.5	37.0	40.49 (1.594)	18.24 (.718)	12.5	8.5	22.4	----- M8 x 1.25	9/16-18	MKM 541	M8 x 50	210
		1179-08-06M8											-----	---	
13	1/2	-8	51.0	56.5	37.0	40.49 (1.594)	18.24 (.718)	12.5	8.5	22.4	----- M8 x 1.25	3/4-16	MKM 541	M8 x 50	210
		1179-08-08M8											-----	---	
19	3/4	-8	63.5	71.5	43.0	50.80 (2.000)	23.80 (.937)	19.0	10.5	25.4	----- M10 x 1.5	3/4-16	MKM 542	M10 x 60	214
		1179-12-08M10											-----	---	
19	3/4	-12	63.5	71.5	43.0	50.80 (2.000)	23.80 (.937)	19.0	10.5	25.4	----- M10 x 1.5	1 1/16-12	MKM 542	M10 x 60	214
		1179-12-12M10											-----	---	
25	1	-12	76.0	81.0	50.0	57.15 (2.250)	27.76 (1.093)	25.0	12.5	28.4	----- M12 x 1.75	1 1/16-12	MKM 551	M12 x 70	219
		1179-16-12M12											-----	---	
25	1	-16	76.0	81.0	50.0	57.15 (2.250)	27.76 (1.093)	25.0	12.5	28.4	----- M12 x 1.75	1 5/16-12	MKM 551	M12 x 70	219
		1179-16-16M12											-----	---	
32	1 1/4	-16	101.5	95.5	62.0	66.68 (2.625)	31.75 (1.250)	31.5	13.0	35.0	----- M12 x 1.75	1 5/16-12	MKM 578	M12 x 80	222
		1179-20-16M12											-----	---	
32	1 1/4	-16	101.5	95.5	62.0	66.68 (2.625)	31.75 (1.250)	31.5	15.0	35.0	----- M14 x 2	1 5/16-12	MKM 1530	M14 x 80	222
		1179-20-16M14*											-----	---	
32	1 1/4	-20	101.5	95.5	62.0	66.68 (2.625)	31.75 (1.250)	31.5	13.0	35.0	----- M12 x 1.75	1 5/8-12	MKM 578	M12 x 80	222
		1179-20-20M12											-----	---	
32	1 1/4	-20	101.5	95.5	62.0	66.68 (2.625)	31.75 (1.250)	31.5	15.0	35.0	----- M14 x 2	1 5/8-12	MKM 1530	M14 x 80	222
		1179-20-20M14*											-----	---	
38	1 1/2	-20	101.5	114.5	75.0	79.38 (3.125)	36.50 (1.437)	38.0	17.0	41.1	----- M16 x 2	1 5/8-12	MKM 553	M16 x 100	225
		1179-24-20M16											-----	---	
38	1 1/2	-24	101.5	114.5	75.0	79.38 (3.125)	36.50 (1.437)	38.0	17.0	41.1	----- M16 x 2	1 7/8-12	MKM 553	M16 x 100	225
		1179-24-24M16											-----	---	
51	2	-32	127.0	133.5	100.0	96.82 (3.812)	44.45 (1.750)	49.2	21.0	50.8	----- M20 x 2.5	2 1/2-12	MKM 1507	M20 x 130	228
		1179-32-32M20											-----	---	

① Order Separately    ③ The pressure rating of the assembly should not exceed the lower of the flange pad or the fitting. Check the fitting manufacturer for details.    MATERIAL : STEEL  
 \* Non Standard Bolt For This Flange Size.    NOTE: DIMENSIONS ARE IN MILLIMETERS. INCH EQUIVALENTS IN ().    1/07