

Developers and Manufacturers of Hydraulic Flanges & Components

FLANGED TEE FLANGES

SAE BOLT PATTERN

62 SERIES

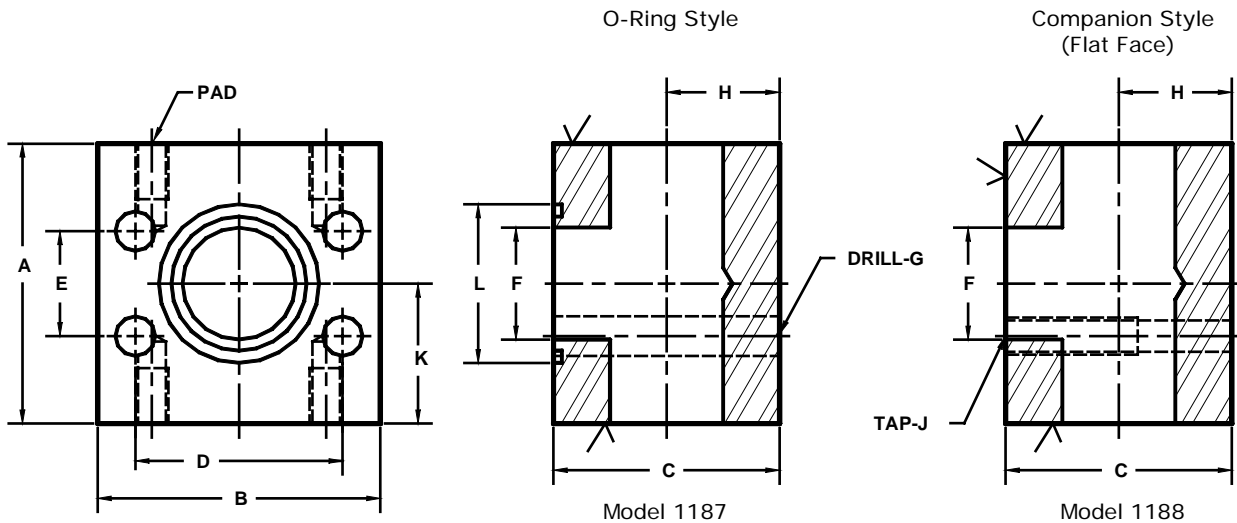

FLANGE SIZE	PAD SIZE	PART NUMBER	A	B	C	D	E	F	G	H	J	K	L	MOUNTING KIT [Ⓢ]		
														PART NO.	BOLT SIZE	O-RING
1/2	1/2	1187-08-08	2.50	2.22	2.00	1.594	.718	.50	.34	.94	-----	1.25	1.000	MK 575	5/16-18 X 2 1/2	210
		1188-08-08							---					5/16-18	-----	---
1/2	3/4	1187-08-12	3.00	2.82	2.50	1.594	.718	.50	.34	1.19	-----	1.50	1.000	MK 1505	5/16-18 X 3	210
		1188-08-12							---					5/16-18	-----	---
3/4	1/2	1187-12-08	3.00	2.82	2.50	2.000	.937	.75	.41	1.19	-----	1.50	1.250	MK 595	3/8-16 X 3 1/4	214
		1188-12-08							---					3/8-16	-----	---
3/4	3/4	1187-12-12	3.00	2.82	2.50	2.000	.937	.75	.41	1.19	-----	1.50	1.250	MK 595	3/8-16 X 3 1/4	214
		1188-12-12							---					3/8-16	-----	---
3/4	1	1187-12-16	4.00	3.19	3.00	2.000	.937	.75	.41	1.38	-----	2.00	1.250	MK 3519	3/8-16 X 3 3/4	214
		1188-12-16							---					3/8-16	-----	---
1	1/2	1187-16-08	3.50	3.19	3.00	2.250	1.093	1.00	.47	1.38	-----	1.75	1.562	MK 596	7/16-14 X 4	219
		1188-16-08							---					7/16-14	-----	---
1	3/4	1187-16-12	3.50	3.19	3.00	2.250	1.093	1.00	.47	1.38	-----	1.75	1.562	MK 596	7/16-14 X 4	219
		1188-16-12							---					7/16-14	-----	---
1	1	1187-16-16	3.50	3.19	3.00	2.250	1.093	1.00	.47	1.38	-----	1.75	1.562	MK 596	7/16-14 X 4	219
		1188-16-16							---					7/16-14	-----	---
1	1 1/4	1187-16-20	3.50	3.75	4.00	2.250	1.093	1.00	.47	1.62	-----	1.75	1.562	MK 3594	7/16-14 X 5	219
		1188-16-20							---					7/16-14	-----	---
1 1/4	1/2	1187-20-08	4.00	3.75	2.50	2.625	1.250	1.25	.53	1.19	-----	2.00	1.750	MK 1530	1/2-13 X 3 1/2	222
		1188-20-08							---					1/2-13	-----	---
1 1/4	3/4	1187-20-12	4.00	3.75	2.50	2.625	1.250	1.25	.53	1.19	-----	2.00	1.750	MK 1530	1/2-13 X 3 1/2	222
		1188-20-12							---					1/2-13	-----	---
1 1/4	1	1187-20-16	4.00	3.75	3.50	2.625	1.250	1.25	.53	1.62	-----	2.00	1.750	MK 4565	1/2-13 X 4 1/2	222
		1188-20-16							---					1/2-13	-----	---
1 1/4	1 1/4	1187-20-20	4.00	3.75	3.50	2.625	1.250	1.25	.53	1.62	-----	2.00	1.750	MK 4565	1/2-13 X 4 1/2	222
		1188-20-20							---					1/2-13	-----	---
1 1/4	1 1/2	1187-20-24	4.50	4.50	4.00	2.625	1.250	1.25	.53	1.75	-----	2.25	1.750	MK 2564	1/2-13 X 5	222
		1188-20-24							---					1/2-13	-----	---

Ⓢ Order Separately

MATERIAL : STEEL
1/07

Developers and Manufacturers of Hydraulic Flanges & Components

FLANGED TEE FLANGES

SAE BOLT PATTERN

62 SERIES

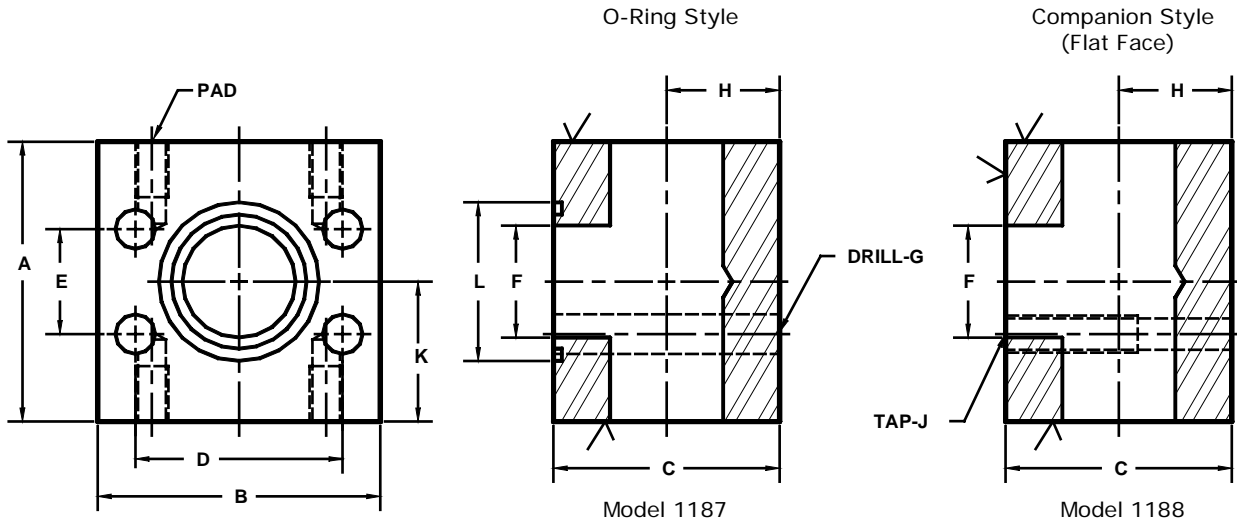

FLANGE SIZE	PAD SIZE	PART NUMBER	A	B	C	D	E	F	G	H	J	K	L	MOUNTING KIT ^①		
														PART NO.	BOLT SIZE	O-RING
1½	¾	1187-24-12	4.00	4.50	3.00	3.125	1.437	1.50	.66	1.50	----	2.00	2.125	MK 553	5/8-11 X 4	225
		1188-24-12							---		5/8-11		----	----		
1½	1	1187-24-16	4.00	4.50	3.00	3.125	1.437	1.50	.66	1.50	----	2.00	2.125	MK 553	5/8-11 X 4	225
		1188-24-16							---		5/8-11		----	----		
1½	1¼	1187-24-20	4.00	4.50	4.00	3.125	1.437	1.50	.66	2.00	----	2.00	2.125	MK 597	5/8-11 X 5	225
		1188-24-20							---		5/8-11		----	----		
1½	1½	1187-24-24	4.50	4.50	4.00	3.125	1.437	1.50	.66	1.88	----	2.25	2.125	MK 597	5/8-11 X 5	225
		1188-24-24							---		5/8-11		----	----		
1½	2	1187-24-32	5.50	5.50	5.00	3.125	1.437	1.50	.66	2.50	----	2.75	2.125	MK 3503	5/8-11 X 6	225
		1188-24-32							---		5/8-11		----	----		
2	1¼	1187-32-20	5.00	5.25	4.00	3.812	1.750	1.94	.78	2.00	----	2.50	2.500	MK 1507	3/4-10 X 5	228
		1188-32-20							---		3/4-10		----	----		
2	1½	1187-32-24	5.00	5.25	4.50	3.812	1.750	1.94	.78	2.00	----	2.50	2.500	MK 4580	3/4-10 X 5 1/2	228
		1188-32-24							---		3/4-10		----	----		
2	2	1187-32-32	5.00	5.25	5.00	3.812	1.750	1.94	.78	2.25	----	2.50	2.500	MK 598	3/4-10 X 6	228
		1188-32-32							---		3/4-10		----	----		
2	2½	1187-32-40	6.00	7.00	5.00	3.812	1.750	1.94	.78	2.47	----	3.00	2.500	MK 598	3/4-10 X 6	228
		1188-32-40							---		3/4-10		----	----		
2½ ^②	2	1187-40-32	7.00	7.00	5.00	4.875	2.312	2.44	.94	2.50	----	3.50	3.000	MK 1596	7/8-9 X 6 1/2	232
		1188-40-32							---		7/8-9		----	----		
2½ ^②	2½	1187-40-40	7.00	7.00	5.00	4.875	2.312	2.44	.94	2.50	----	3.50	3.000	MK 1596	7/8-9 X 6 1/2	232
		1188-40-40							---		7/8-9		----	----		
2½ ^②	3	1187-40-48	8.00	8.50	6.00	4.875	2.312	2.44	.94	3.00	----	4.00	3.000	MK 5544	7/8-9 X 7 1/2	232
		1188-40-48							---		7/8-9		----	----		
3 ^②	2½	1187-48-40	8.00	8.50	5.00	6.000	2.812	2.94	1.19	2.50	----	4.00	3.625	MK 756	1 1/8-7 X 7	237
		1188-48-40							---		1 1/8-7		----	----		
3 ^②	3	1187-48-48	9.00	8.50	6.00	6.000	2.812	2.94	1.19	3.00	----	4.50	3.625	MK 2758	1 1/8-7 X 8	237
		1188-48-48							---		1 1/8-7		----	----		

① Order Separately ② Not included in SAE J518 specifications

MATERIAL : STEEL
1/07