

Developers and Manufacturers of Hydraulic Flanges & Components

## SOCKET WELD IN-LINE PIPE FLANGES

ISO 6164			250 BAR SERIES														
FLANGE SIZE	PIPE SIZE	PART NUMBER	A	B	C	D <sub>mm</sub>	E	F	G <sub>mm</sub>	H	J <sub>mm</sub>	K	L	MOUNTING KIT <sup>Ⓞ</sup>			
														PART NO.	BOLT SIZE	O-RING	
10	3/8	1631-06-06M	PLEASE USE THE 400 BAR SERIES FOUND BELOW. THE BLOCK SIZE, BOLT PATTERN AND THE O'RING ARE IDENTICAL IN FLANGE SIZES 10 - 38. IF YOU HAVE ANY QUESTIONS CALL ENGINEERING AT 1-800-521-7918.														
		1632-06-06M															
13	1/2	1631-08-08M															
		1632-08-08M															
19	3/4	1631-12-12M															
		1632-12-12M															
25	1	1631-16-16M															
		1632-16-16M															
32	1 1/4	1631-20-20M															
		1632-20-20M															
38	1 1/2	1631-24-24M															
		1632-24-24M															
51	2	1631-32-32M															
		1632-32-32M	-----	-----	-----	-----	-----	-----	-----	-----	M16 x 2	-----	-----	-----	-----	-----	
56	2 1/2	1631-40-40M	4.75	2.38	1.88	118	3.285	2.44	22.0	.75	-----	2.911	3.000	MKM 5573	M20 x 80	232	
		1632-40-40M	-----	-----	-----	-----	-----	-----	-----	-----	M20 x 2.5	-----	-----	-----	-----	-----	
63	3	1631-48-48M	5.50	2.75	2.28	145	4.037	2.94	22.0	.75	-----	3.540	3.625	MKM 5558	M20 x 90	237	
		1632-48-48M	-----	-----	-----	-----	-----	-----	-----	-----	M20 x 2.5	-----	-----	-----	-----	-----	

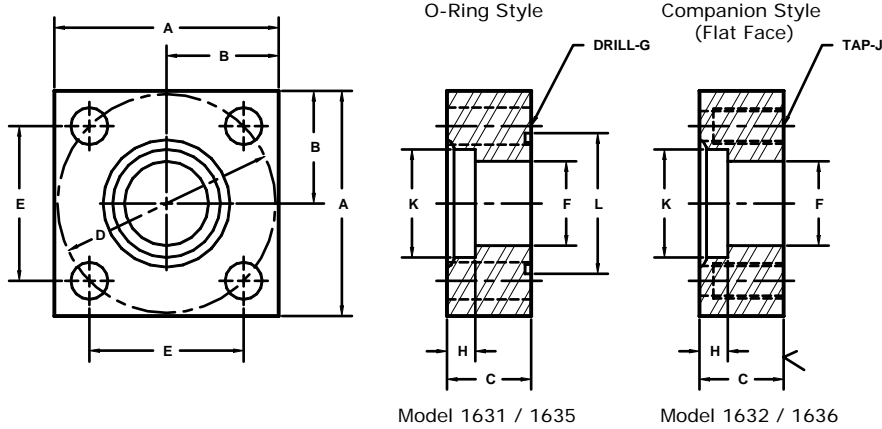

ISO 6164			400 BAR SERIES														
FLANGE SIZE	PIPE SIZE	PART NUMBER	A	B	C	D <sub>mm</sub>	E	F	G <sub>mm</sub>	H	J <sub>mm</sub>	K	L	MOUNTING KIT <sup>Ⓞ</sup>			
														PART NO.	BOLT SIZE	O-RING	
10	3/8	1635-06-06M	PLEASE USE THE 400 BAR SERIES FOUND BELOW. THE BLOCK SIZE, BOLT PATTERN AND THE O'RING ARE IDENTICAL IN FLANGE SIZES 10 - 38. IF YOU HAVE ANY QUESTIONS CALL ENGINEERING AT 1-800-521-7918.														
		1636-06-06M															
13	1/2	1635-08-08M															
		1636-08-08M															
19	3/4	1635-12-12M															
		1636-12-12M															
25	1	1635-16-16M															
		1636-16-16M															
32	1 1/4	1635-20-20M															
		1636-20-20M															
38	1 1/2	1635-24-24M															
		1636-24-24M															
51	2	1635-32-32M															
		1636-32-32M	-----	-----	-----	-----	-----	-----	-----	-----	M16 x 2	-----	-----	-----	-----	-----	
56	2 1/2	1635-40-40M	4.75	2.38	1.98	118	3.285	2.12	22.0	.75	-----	2.911	3.125	MKM 5538	M20 x 80	335	
		1636-40-40M	-----	-----	-----	-----	-----	-----	-----	-----	M20 x 2.5	-----	-----	-----	-----	-----	
63	3	1635-48-48M	6.00	3.00	2.12	145	4.037	2.32	26.0	.75	-----	3.540	3.375	MKM 5561	M24 x 90	337	
		1636-48-48M	-----	-----	-----	-----	-----	-----	-----	-----	M24 x 3	-----	-----	-----	-----	-----	
70	3 1/2	1635-56-56M	6.50	3.25	2.46	160	4.454	2.73	26.0	.75	-----	4.045	3.750	MKM 5562	M24 x 100	340	
		1636-56-56M	-----	-----	-----	-----	-----	-----	-----	-----	M24 x 3	-----	-----	-----	-----	-----	
80	4	1635-64-64M	7.00	3.50	2.85	175	4.872	3.15	33.0	.75	-----	4.550	3.875	MKM 5563	M30 x 120	341	
		1636-64-64M	-----	-----	-----	-----	-----	-----	-----	-----	M30 x 3.5	-----	-----	-----	-----	-----	

Ⓞ Order Separately

MATERIAL : STEEL  
1/07

NOTE: DIMENSIONS ARE IN INCHES UNLESS OTHERWISE NOTED.