

Developers and Manufacturers of Hydraulic Flanges & Components

SOCKET WELD IN-LINE TUBE FLANGES

SAE BOLT PATTERN

62 SERIES

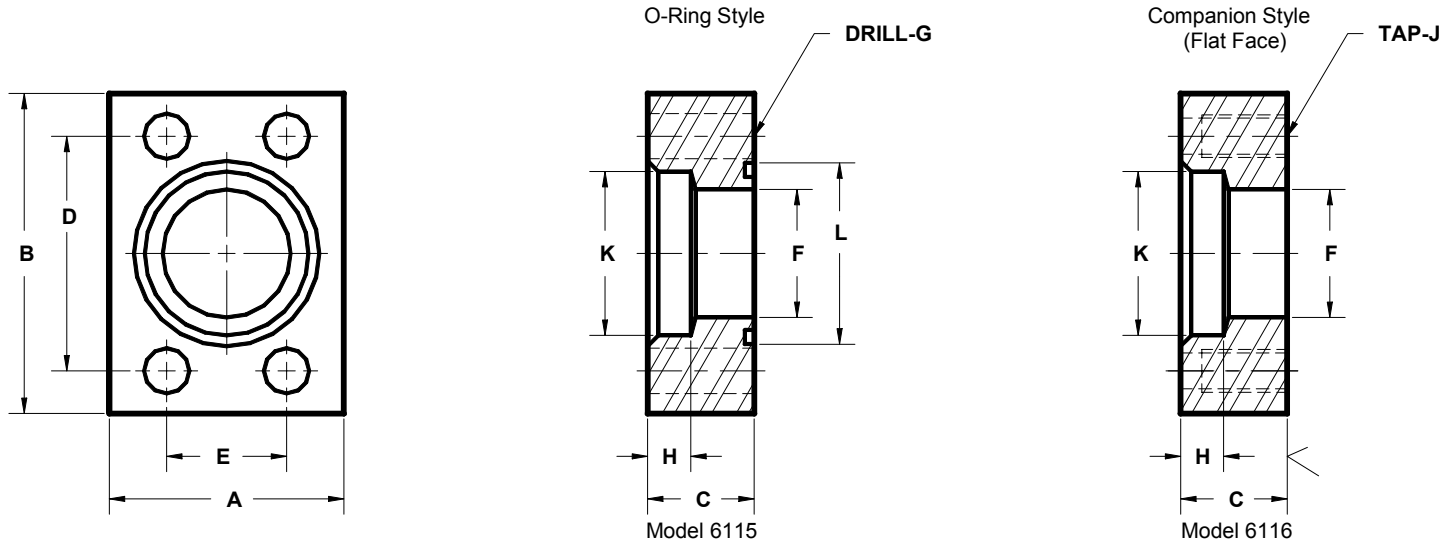

FLANGE SIZE	TUBE SIZE	PART NUMBER	A	B	C	D	E	F	Gmm	H	Jmm	K	L	MOUNTING KIT ^①			WT
														PART NO.	BOLT SIZE	O-RING	
1/2	1/2	6115-08-08DM8	1.75	2.22	1.00	1.594	.718	.38	8.5	.50	----	.510	1.000	MKM 512	M8 x 35	210	.9
		6116-08-08DM8							---		---		---				
1/2	3/4	6115-08-12DM8	1.75	2.22	1.00	1.594	.718	.50	8.5	.50	----	.760	1.000	MKM 512	M8 x 35	210	.8
		6116-08-12DM8							---		---		---				
3/4	3/4	6115-12-12DM10	2.00	2.81	1.00	2.000	.937	.50	10.5	.50	----	.760	1.250	MKM 502	M10 x 40	214	1.4
		6116-12-12DM10							---		---		---				
3/4	7/8	6115-12-14DM10	2.00	2.81	1.00	2.000	.937	.75	10.5	.50	----	.885	1.250	MKM 502	M10 x 40	214	1.3
		6116-12-14DM10							---		---		---				
3/4	1	6115-12-16DM10	2.00	2.81	1.00	2.000	.937	.75	10.5	.50	----	1.010	1.250	MKM 502	M10 x 40	214	1.2
		6116-12-16DM10							---		---		---				
1	1	6115-16-16DM12	2.25	3.19	1.00	2.250	1.093	.75	12.5	.50	----	1.010	1.562	MKM 513	M12 x 45	219	1.7
		6116-16-16DM12							---		---		---				
1	1 1/4	6115-16-20DM12	2.25	3.19	1.00	2.250	1.093	1.00	12.5	.50	----	1.260	1.562	MKM 513	M12 x 45	219	1.5
		6116-16-20DM12							---		---		---				
1 1/4	1 1/4	6115-20-20DM12	2.75	3.75	1.25	2.625	1.250	1.00	13.0	.50	----	1.260	1.750	MKM1502	M12 x 50	222	3.0
		6116-20-20DM12							---		---		---				
1 1/4	1 1/2	6115-20-24DM12	2.75	3.75	1.25	2.625	1.250	1.25	13.0	.50	----	1.510	1.750	MKM 1502	M12 x 50	222	2.7
		6116-20-24DM12							---		---		---				
1 1/2	1 1/2	6115-24-24DM16	3.25	4.50	1.50	3.125	1.437	1.25	17.0	.50	----	1.510	2.125	MKM 515	M16 x 60	225	5.1
		6116-24-24DM16							---		---		---				
1 1/2	1 3/4	6115-24-28DM16	3.25	4.50	1.50	3.125	1.437	1.50	17.0	.50	----	1.760	2.125	MKM 515	M16 x 60	225	4.9
		6116-24-28DM16							---		---		---				
1 1/2	2	6115-24-32DM16	3.25	4.50	1.50	3.125	1.437	1.50	17.0	.50	----	2.010	2.125	MKM 515	M16 x 60	225	4.7
		6116-24-32DM16							---		---		---				
2	2	6115-32-32DM20	4.00	5.25	1.75	3.812	1.750	1.50	21.0	.62	----	2.010	2.500	MKM 516	M20 x 70	228	8.0
		6116-32-32DM20							---		---		---				
2	2 1/4	6115-32-36DM20	4.00	5.25	1.75	3.812	1.750	1.94	21.0	.62	----	2.260	2.500	MKM 516	M20 x 70	228	7.5
		6116-32-36DM20							---		---		---				

① Order Separately

MATERIAL : 316L STAINLESS STEEL

NOTE: DIMENSIONS ARE IN INCHES UNLESS OTHERWISE NOTED.

7/01