

Developers and Manufacturers of
Hydraulic Flanges & Components

NPTF THREADED ELBOW FLANGES

SAE BOLT PATTERN			61 SERIES														
FLANGE SIZE	PIPE SIZE	PART NUMBER	A	B	C	D	E	F	G	H	J	K	L	MOUNTING KIT ^①			WT
														PART NO.	BOLT SIZE	O-RING	
1/2	1/2	6161-08-08B	2.00	2.12	1.44	1.500	.688	.50	.34	.75	5/16-18	1/2	1.000	MK 541	5/16-18 X 2	210	1.5
		6162-08-08B							---								
3/4	3/4	6161-12-12B	2.50	2.62	1.70	1.875	.875	.75	.41	.88	3/8-16	3/4	1.250	MK 542	3/8-16 X 2 1/2	214	2.6
		6162-12-12B							---								
1	1	6161-16-16B	3.00	2.82	1.94	2.062	1.031	1.00	.41	1.00	3/8-16	1	1.562	MK 543	3/8-16 X 2 3/4	219	3.5
		6162-16-16B							---								
1 1/4	1 1/4	6161-20-20B	3.50	3.19	2.40	2.312	1.188	1.25	.47	1.25	7/16-14	1 1/4	1.750	MK 578	7/16-14 X 3 1/4	222	6.2
		6162-20-20B							---								
1 1/2	1 1/2	6161-24-24B	4.00	3.75	2.90	2.750	1.406	1.50	.53	1.38	1/2-13	1 1/2	2.125	MK 545	1/2-13 X 4	225	9.9
		6162-24-24B							---								
2	2	6161-32-32B	4.50	4.00	2.96	3.062	1.688	1.94	.53	1.62	1/2-13	2	2.500	MK 558	1/2-13 X 4	228	10.7
		6162-32-32B							---								
2 1/2 ^②	2 1/2	6161-40-40B	5.00	4.50	3.96	3.500	2.000	2.44	.53	2.00	1/2-13	2 1/2	3.000	MK 547	1/2-13 X 5	232	17.7
		6162-40-40B							---								
3 ^③	3	6161-48-48B	6.00	5.31	4.46	4.188	2.438	2.94	.66	2.25	5/8-11	3	3.625	MK 2532	5/8-11 X 5 1/2	237	27.6
		6162-48-48B							---								

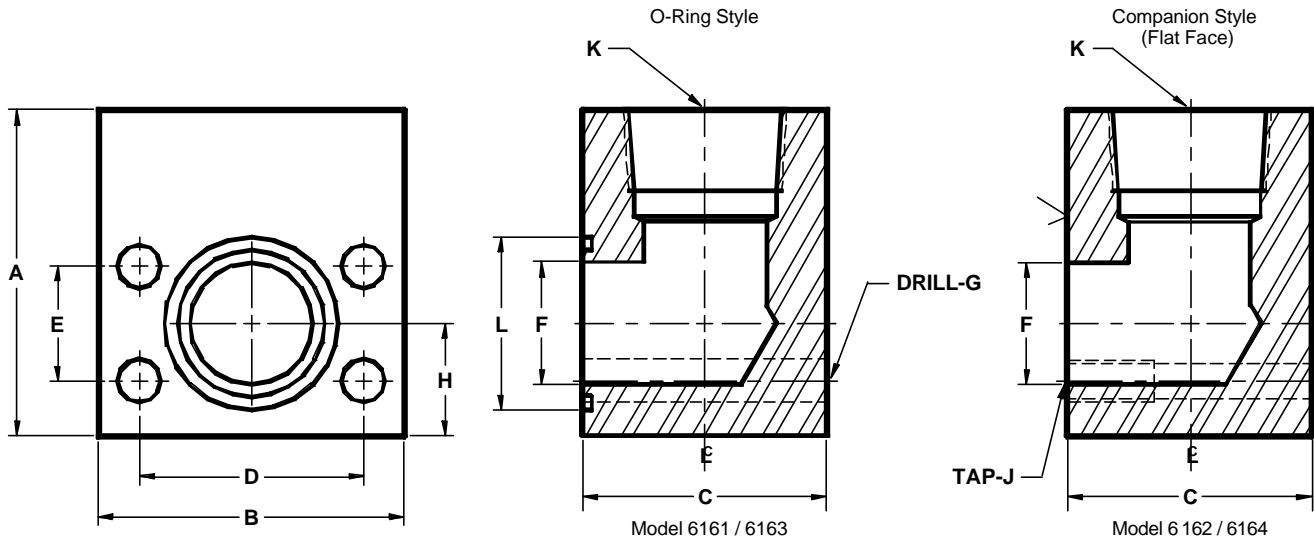

SAE BOLT PATTERN			62 SERIES														
FLANGE SIZE	PIPE SIZE	PART NUMBER	A	B	C	D	E	F	G	H	J	K	L	MOUNTING KIT ^①			WT
														PART NO.	BOLT SIZE	O-RING	
1/2	1/2	6163-08-08B	2.00	2.22	1.46	1.594	.718	.50	.34	.88	5/16-18	1/2	1.000	MK 541	5/16-18 X 2	210	1.6
		6164-08-08B							---								
3/4	3/4	6163-12-12B	2.50	2.81	1.70	2.000	.937	.75	.41	1.00	3/8-16	3/4	1.250	MK 542	3/8-16 X 2 1/2	214	2.8
		6164-12-12B							---								
1	1	6163-16-16B	3.00	3.19	1.96	2.250	1.093	1.00	.47	1.12	7/16-14	1	1.562	MK 551	7/16-14 X 2 3/4	219	4.4
		6164-16-16B							---								
1 1/4	1 1/4	6163-20-20B	4.00	3.75	2.44	2.625	1.250	1.25	.53	1.38	1/2-13	1 1/4	1.750	MK 552	1/2-13 X 3 1/4	222	6.7
		6164-20-20B							---								
1 1/2	1 1/2	6163-24-24B	4.00	4.50	2.96	3.125	1.437	1.50	.66	1.62	5/8-11	1 1/2	2.125	MK 553	5/8-11 X 4	225	12.1
		6164-24-24B							---								
2	2	6163-32-32B	5.00	5.25	3.46	3.812	1.750	1.94	.78	2.00	3/4-10	2	2.500	MK 554	3/4-10 X 4 1/2	228	20.2
		6164-32-32B							---								
2 1/2 ^④	2 1/2	6163-40-40B	6.00	6.88	4.00	4.875	2.312	2.44	.94	2.50	7/8-9	2 1/2	3.000	MK 555	7/8-9 X 5 1/2	232	37.9
		6164-40-40B							---								
3 ^④	3	6163-48-48B	7.00	8.50	5.00	6.000	2.812	2.94	1.19	3.00	1 1/8-7	3	3.625	MK 756	1 1/8-7 X 7	237	69.0
		6164-48-48B							---								

① Order Separately ② 2500 PSI Max ③ 2000 PSI Max ④ Not included in SAE J518 specifications

MATERIAL : 304L STAINLESS STEEL
10/00