

Developers and Manufacturers of Hydraulic Flanges & Components

## NPTF THREADED ELBOW FLANGES

SAE BOLT PATTERN										61 SERIES							
FLANGE SIZE	PIPE SIZE	PART NUMBER	A	B	C	D	E	F	Gmm	H	Jmm	K	L	MOUNTING KIT <sup>①</sup>			WT
														PART NO.	BOLT SIZE	O-RING	
1/2	1/2	6161-08-08DM8	2.00	2.12	1.44	1.500	.688	.50	8.5	.75	----	1/2	1.000	MKM 541	M8 x 50	210	1.5
		---							M8 x 1.25		---						
3/4	3/4	6161-12-12DM10	2.50	2.62	1.70	1.875	.875	.75	10.5	.88	----	3/4	1.250	MKM 542	M10 x 60	214	2.6
		---							M10 x 1.5		---						
1	1	6161-16-16DM10	3.00	2.82	1.94	2.062	1.031	1.00	10.5	1.00	----	1	1.562	MKM 543	M10 x 65	219	3.5
		---							M10 x 1.5		---						
1 1/4	1 1/4	6161-20-20DM10	3.50	3.19	2.40	2.312	1.188	1.25	10.5	1.25	----	1 1/4	1.750	MKM 4532	M10 x 75	222	6.2
		---							M10 x 1.5		---						
1 1/2	1 1/2	6161-24-24DM12	4.00	3.75	2.90	2.750	1.406	1.50	13.0	1.38	----	1 1/2	2.125	MKM 4533	M12 x 90	225	9.9
		---							M12 x 1.75		---						
2	2	6161-32-32DM12	4.50	4.00	2.96	3.062	1.688	1.94	13.0	1.62	----	2	2.500	MKM 4547	M12 x 90	228	10.7
		---							M12 x 1.75		---						
2 1/2 <sup>②</sup>	2 1/2	6161-40-40DM12	5.00	4.50	3.96	3.500	2.000	2.44	13.0	2.00	----	2 1/2	3.000	MKM 4535	M12 x 120	232	17.7
		---							M12 x 1.75		---						
3 <sup>③</sup>	3	6161-48-48DM16	6.00	5.31	4.46	4.188	2.438	2.94	17.0	2.25	----	3	3.625	MKM 2532	M16 x 140	237	27.6
		---							M16 x 2		---						

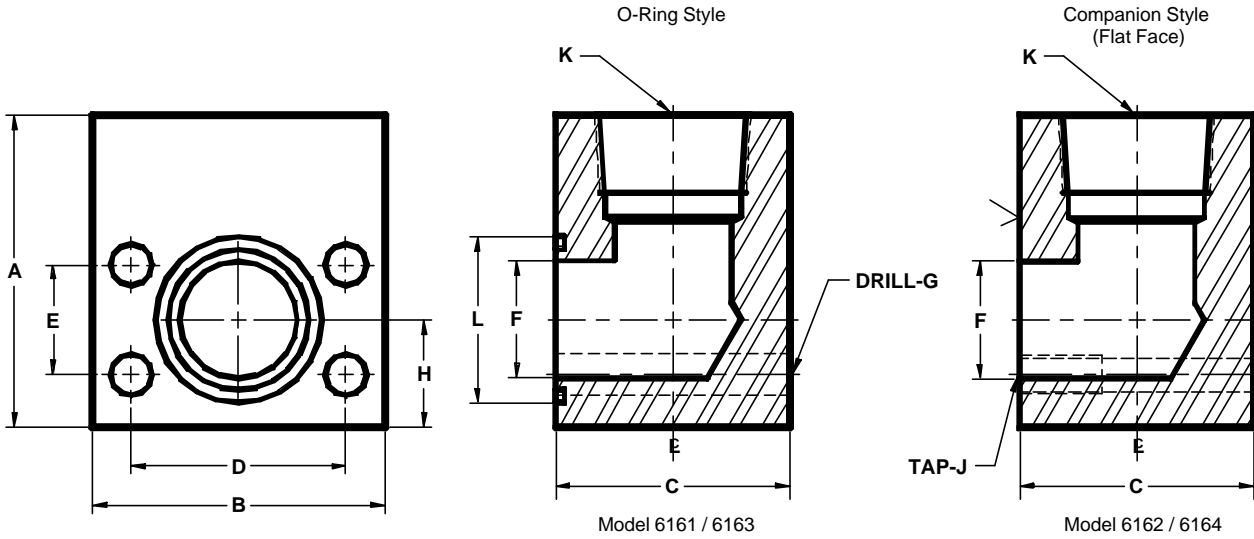

SAE BOLT PATTERN										62 SERIES							
FLANGE SIZE	PIPE SIZE	PART NUMBER	A	B	C	D	E	F	Gmm	H	Jmm	K	L	MOUNTING KIT <sup>①</sup>			WT
														PART NO.	BOLT SIZE	O-RING	
1/2	1/2	6163-08-08DM8	2.00	2.22	1.46	1.594	.718	.50	8.5	.88	----	1/2	1.000	MKM 541	M8 x 50	210	1.6
		---							M8 x 1.25		---						
3/4	3/4	6163-12-12DM10	2.50	2.81	1.70	2.000	.937	.75	10.5	1.00	----	3/4	1.250	MKM 542	M10 x 60	214	2.8
		---							M10 x 1.5		---						
1	1	6163-16-16DM12	3.00	3.19	1.96	2.250	1.093	1.00	12.5	1.12	----	1	1.562	MKM 551	M12 x 70	219	4.4
		---							M12 x 1.75		---						
1 1/4	1 1/4	6163-20-20DM12	4.00	3.75	2.44	2.625	1.250	1.25	13.0	1.38	----	1 1/4	1.750	MKM 578	M12 x 80	222	6.7
		---							M12 x 1.75		---						
1 1/2	1 1/2	6163-24-24DM16	4.00	4.50	2.96	3.125	1.437	1.50	17.0	1.62	----	1 1/2	2.125	MKM 553	M16 x 100	225	12.1
		---							M16 x 2		---						
2	2	6163-32-32DM20	5.00	5.25	3.46	3.812	1.750	1.94	21.0	2.00	----	2	2.500	MKM 554	M20 x 120	228	20.2
		---							M20 x 2.5		---						
2 1/2 <sup>④</sup>	2 1/2	6163-40-40DM24	6.00	6.88	4.00	4.875	2.312	2.44	25.5	2.50	----	2 1/2	3.000	MKM 555	M24 x 140	232	37.9
		---							M24 x 3		---						
3 <sup>④</sup>	3	6163-48-48DM30	7.00	8.50	5.00	6.000	2.812	2.94	32.0	3.00	----	3	3.625	MKM 556	M30 x 180	237	69.0
		---							M30 x 3.5		---						

① Order Separately ② 2500 PSI Max ③ 2000 PSI Max ④ Not included in SAE J518 specifications

MATERIAL: 316L STAINLESS STEEL

NOTE: DIMENSIONS ARE IN INCHES UNLESS OTHERWISE NOTED.

10/01