

# FLANGE ADAPTERS

MODEL NUMBERS (AVAILABLE AS INCREASER, REDUCER AND PAD ROTATORS)

**MODEL**  
1339  
1341

**ADAPTER BLOCK HAS:**  
C62 O-Ring, C61 Flat Faced  
C62 O-Ring, C62 Flat Faced

**MODEL**  
1340  
1342

**ADAPTER BLOCK HAS:**  
C62 Flat Faced, C61 Flat Faced  
C62 Flat Faced, C62 Flat Faced

SAE BOLT PATTERN			62 SERIES TO 61 SERIES										MOUNTING KIT <sup>Ⓢ</sup>		
PAD 1 C62	PAD 2 C61	PART NUMBER	A	B	C	D	E	F	G	H	J	K	PART NO.	BOLT SIZE	O-RING
1/2	1/2	1339-08-08	2.25	2.25	1.00	1.594	.718	.50	.34	5/16-18	1.500	.688	MK 564	5/16-18 x 1	210
3/4	3/4	1339-12-12	2.81	2.75	1.00	2.000	.937	.75	.41	3/8-16	1.875	.875	MK 565	3/8-16 x 1	214
1	1	1339-16-16	3.19	3.00	1.25	2.250	1.093	1.00	.47	3/8-16	2.062	1.031	MK 569	7/16-14 x 1 1/4	219
1 1/4	1 1/4	1339-20-20	3.75	3.25	1.25	2.625	1.250	1.25	.53	7/16-14	2.312	1.188	MK 570	1/2-13 x 1 1/4	222
1 1/2	1 1/2	1339-24-24	4.50	3.75	1.50	3.125	1.437	1.50	.66	1/2-13	2.750	1.406	MK 571	5/8-11 x 1 1/2	225
2	2	1339-32-32	5.25	4.00	1.75	3.812	1.750	1.94	.78	1/2-13	3.062	1.688	MK 563	3/4-10 x 2	228
2 1/2 <sup>④</sup>	2 1/2 <sup>②</sup>	1339-40-40	6.88	5.00	2.00	4.875	2.312	2.44	.94	1/2-13	3.500	2.000	MK 1513	7/8-9 x 2 1/4	232
3 <sup>④</sup>	3 <sup>③</sup>	1339-48-48	8.50	6.00	2.50	6.000	2.812	2.94	1.19	5/8-11	4.188	2.438	MK 1514	1 1/8-7 x 2 1/2	237

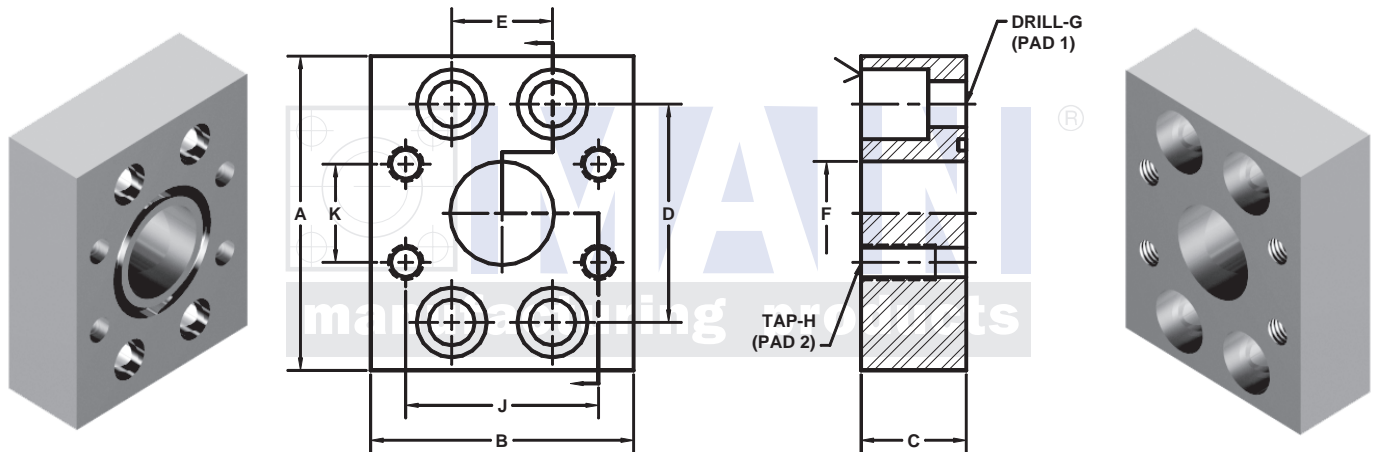

3181 TRI-PARK DR. GRAND BLANC, MI 48439 800-521-7918 810-953-1380 FAX 810-953-1385 INFO@MAINMFG.COM

SAE BOLT PATTERN			62 SERIES TO 62 SERIES										MOUNTING KIT <sup>Ⓢ</sup>		
PAD 1 C62	PAD 2 C62	PART NUMBER	A	B	C	D	E	F	G	H	J	K	PART NO.	BOLT SIZE	O-RING
3/4	1/2	1341-12-08	2.81	2.25	1.50	2.000	.937	.50	.41	5/16-18	1.594	.718	MK 1525	3/8-16 x 1 1/2	214
1	3/4	1341-16-12	3.19	3.00	1.75	2.250	1.093	.75	.47	3/8-16	2.000	.937	MK 513	7/16-14 x 1 3/4	219
1 1/4	1	1341-20-16	3.75	3.25	1.75	2.625	1.250	1.00	.53	7/16-14	2.250	1.093	MK 529	1/2-13 x 1 3/4	222
1 1/2	1 1/4	1341-24-20	4.50	3.75	2.00	3.125	1.437	1.25	.66	1/2-13	2.625	1.250	MK 562	5/8-11 x 2	225
2	1 1/2	1341-32-24	5.25	4.50	2.25	3.812	1.750	1.50	.78	5/8-11	3.125	1.437	MK 1548	3/4-10 x 2 1/2	228
2 1/2 <sup>④</sup>	2	1341-40-32	7.00	5.25	2.50	4.875	2.312	1.94	.94	3/4-10	3.812	1.750	MK 1575	7/8-9 x 2 3/4	232
3 <sup>④</sup>	2 1/2	1341-48-40	8.50	7.00	2.50	6.000	2.812	2.44	1.19	7/8-9	4.875	2.312	MK 1514	1 1/8-7 x 2 1/2	237

① Order Separately ② 2500 PSI Max ③ 2000 PSI Max ④ Not included in SAE J518 specifications

**CAUTION:** Flange adapter pressure rating cannot exceed 61 series pad connection.